



News

Tamborine Mountain, Canungra, Tamborine, Beechmont, Beaudesert, Cedar Creek, Boyland

*Celebrating 63 years of unbroken publication...
www.scenicnews.com.au*



SOUTH EAST TESTED BY LATE SUMMER FLOODING

The Scenic Rim and Gold Coast Hinterland has endured – along with most of South East Queensland – an extraordinary burst of late summer weather.

Communities across the region have shown great spirit and goodwill in dealing with the floods, but assistance is very much required from local, state and federal government.

See pages 3, 7 and 12 for various remedies and resources available to those affected.

The scene above was captured near Boonah, which experienced further flash flooding last Sunday. Photo: SES



Canungra Dental

Implants
Wisdom Teeth
Crowns
Twilight Sedation
Teeth Whitening

Your cosmetic and family dentists!
Canungra Dental (07) 5543 5299

NEW PATIENTS WELCOME



Property of the week

SALE 🛏️ 3 🚿 2 🚗 2 🏠 913m²

The perfect place to call home \$949,000+
73 Coomera Gorge Drive, Tamborine Mountain

- Gold Coast views, generous outdoor entertainment areas
- Complete renovation, just move in and enjoy your new home
- 9 ft ceilings, large windows for natural light
- Single garage/ workshop & carport
- Located in the quiet Golf Course Estate

AGENTS:

Diane Pihl
0424 653 316



Property of the week

SALE 🛏️ 4 🚿 3 🚗 4 🏠 2.71 acres

Tranquil, dual living acreage \$949,000 +
32 Kestrel Court, Tamborine

- Peaceful surrounds backing onto Birnam State Forest
- Dual living with upstairs main dwelling, downstairs granny flat
- Both open plan with outdoor living areas
- Dam, shed, chicken coop
- Mountain views

AGENTS:

Monique Clemens 0429 004 840
Erin McGee 0427 078 757



PROPERTY MANAGEMENT

Short and long term rentals

Looking for the BEST management team to manage your investment?
You'll be in great hands all year round!
We would love to help you
Call us...

Mountain 5545 4000/ Tamborine 5543 6444

OPEN HOMES Sat 12th

10 - 10.30	207 Macdonnell Road
10 - 10.30	19 Magnetic Drive
11 - 11.30	89 Kinabalu Drive
11 - 11.45	9-11 Lombok Court
12.30 - 1.15	73-75 Alpine Terrace
1 - 1.30	166 Wongawallan Drive

≡ International Women's Day ≡



Review: Buyer 21 Wongawallan Road

If you're looking for a strong, local agent then go with the Professionals on the Mount. I bought my current home through Linda Hogan and she was/is amazing! Even well after the sale Linda has been so supportive on other non-sale requests on a number of occasions Very Happy!

★★★★★

AGENTS:

Linda Hogan 0414 300 558



SALE 🛏️ 3 🚿 2 🚗 1 🏠 1900m²

9-11 Lombok Court, Tamborine Mountain

- Quiet cul-de-sac, private with few neighbours, this family home is perfect
- Covered front verandahs, glimpses of GC
- L-shaped, highset with ample storage under the house (currently tenanted)

\$750,000+

AGENTS:

Barry Chick 0418 876 191
Lisa Patrick 0407 642 444



SALE 🛏️ 4 🚿 1 🚗 2 🏠 1,000m²

89 Kinabalu Drive, Tamborine Mountain

- Welcome to this lovely home, come on in
- Open plan, undercover veranda on 3 sides
- Tastefully decorated in neutral colours
- Double carport plus additional spaces
- Retreat downstairs, bedroom, kitchenette

\$849,000 +

AGENTS:

Linda Hogan
0414 300 558



SALE 🛏️ 3 🚿 1 🚗 2 🏠 11.5 acres

166 Wongawallan Drive, Wongawallan

- If you are looking for privacy & magnificent views, this is your property future
- Open plan living, undercover patio off lounge
- Remote controlled security gate and double lockup garage

\$995,000+

AGENTS:

Ton Wolf 0424 591 012
Heleen 0424 591 011



EXTRAORDINARY DISASTER ASSISTANCE TO AID IN SCENIC RIM FLOOD RECOVERY

The latest flood recovery support from the Federal and State Governments will provide loans and grants to impacted farmers, small businesses, and community organisations.

The Federal and State Government have made available a suite of initiatives to help flood-affected primary producers, small businesses, and community groups in the Scenic Rim, that face a massive clean-up operation in the aftermath of the ongoing floods.

Financial help is being provided through the jointly funded Commonwealth-State Disaster Recovery Funding Arrangements (DRFA).

Federal Member for Wright, Scott Buchholz welcomed the inclusion of farmers, small businesses and community groups in the DRFA assistance and said it would be welcome news to Scenic Rim residents.

“We know from previous weather events and natural disasters that extending the assistance to farmers and small businesses, through concessional loans and grants – we are able to get them back on their feet sooner and ease the burden.

“This package provides Council with \$1 million for immediate clean-up activities, makes \$75,000 in grants available for affected primary producers, \$50,000 grants for affected small businesses and not-for-profit organisations and \$20,000 for sport and community clubs,” Mr Buchholz said.

State Member for Scenic Rim, Jon Krause welcomed the further support that will see primary producers access freight subsidies of up to \$5,000 for the movement of stock, feed, machinery, fuel, water and fencing materials.

“In addition, flood affected communities in the Scenic Rim can now access grants of up to a maximum of \$900 for a family of five or more and up to \$180 per person to eligible people experiencing financial hardship because of the floods.

“The latest support package includes concessional loans up to \$250,000 and essential working capital loans of up to \$100,000 to help kick-start the recovery of impacted primary producers, small businesses and not-for-profit organisations,” Mr Krause said.

DRFA low interest loans as well as freight subsidies for eligible primary producers are now available in 17 LGAs: Brisbane, Fraser Coast, Gold Coast, Gympie, Ipswich, Lockyer Valley, Logan, Moreton Bay, Noosa, North Burnett, Redland, Scenic Rim, Somerset, South Burnett, Southern Downs, Sunshine Coast, and Toowoomba.

The grant payments are being provided through the jointly funded Commonwealth-State Disaster Recovery Funding Arrangements for eligible applicants in the 19 local government areas of Brisbane, Fraser Coast, Gladstone, Gold Coast, Goondiwindi, Gympie, Ipswich, Lockyer Valley, Logan, Moreton Bay, Noosa, North Burnett, Redland, Scenic Rim, Somerset, South Burnett, Southern Downs, Sunshine Coast and Toowoomba.

This DRFA assistance is in addition to assistance already available for cases of personal hardship, as well as for councils and agencies for counter disaster operations and the reconstruction of essential infrastructure.

More information: www.qld.gov.au/community/disasters-emergencies/disasters/money-finance/eligibility-apply/seq-flooding-february-2022

ENERGEX RELEASES APPROXIMATE DISASTER-RELATED RESTORATION TIMES ONLINE

Energex crews have been able to finetune estimated restoration dates for much of SEQ, and we’re on track to soon have network supply available to the overwhelming majority of customers in flood-affected areas.

Restoration estimates associated with the current flooding disaster will appear under the “Next Update” field on the Energex “outages” webpage at www.energex.com.au/outages

On the site people can drill down to suburbs and their street location and the approximate restoration time will be under “Next Update” field.

PLEASE NOTE: these are our best estimates and may be affected if we find additional damage in your area that’s not readily apparent, or if flood levels ease more slowly than forecast. We also need the weather to hold off, as storms and further rain would hamper restoration.

These estimated dates and times may be further updated as the restoration progresses – please check regularly. While

ENERGEX URGES THE MUD ARMY TO BE SAFE AROUND ELECTRICAL ASSETS

Energex applauds the community spirit of The Mud Army 2.0 but is urging them and the general public to take care around electrical assets such as poles, substations, powerlines, padmount transformers and pillar boxes.

Energex said its assets must always be treated as live and members of the Mud Army and community should keep clear of them during the clean-up.

Any damaged electrical equipment can be reported to Energex on 13 19 62 or by calling 000.

you may see power in your street you may be on another part of the network that has sustained damage that you cannot see.

Energex crews sincerely thank the community for their patience during this natural disaster.

Stay safe.

Danny Donald
Senior Corporate Communications Advisor
Energex



WE OFFER:

- Weekly community newspaper
- 7100 distributed - to home letterboxes, and to local businesses
- Get your ad in front of more than 20,000 readers each week
- Free online exposure, and online advertising opportunities
- Modern website - great visibility for you
- Social media coverage included with your advertising

#scenicnews +
[facebook.com/scenicnews](https://www.facebook.com/scenicnews)

- Tall A4 size - standout exposure
- High quality gloss print
- 63 years of unbroken publication!
- We cover Tamborine Mountain, Canungra, Tamborine, Cedar Creek & surrounds - bulk drops in Beaudesert

Looking to advertise - reach a bigger audience - have a story to tell?

Call today!

Advertising:

0417 238 238

advertising@scenicnews.com.au

www.scenicnews.com.au/rates

Editor/Production: Andrew Nagy

0432 827 537

info@scenicnews.com.au

editor@scenicnews.com.au

**Advertising?
0417 238 238**

Call or email

advertising@scenicnews.com.au



The toilet block at Staffsmith Park (above) and Examples of the disrepair evidenced on the Judith Wright Boardwalk (below)



These are my own personal views. I do not purport to speak on behalf of Council. Decisions of Council are made only by majority vote, legislative authority or under authority delegated by Council.

Councillor's Comment

DEREK SWANBOROUGH
DIVISION 1



GROWTH MANAGEMENT STRATEGY REPORT

Thank you to all those who have provided a submission so far.

The community consultation period has been extended for a further three weeks. Check Council's website for details scenicrim.qld.gov.au.

COUNCIL LIBRARY DESIGN GETS A FAIL

Following on from my last mention of this, I have learned from a qualified resident, that under the Building Code of Australia a Library is classified as an Assembly Building class 9(b) and it stipulates that male and female toilets are required according to a formula in the code. When I asked the question in the Council meeting of 22nd February, I was also advised that the new Library would be built according to the Code.

So now, after I was advised of the Code requirements, I note the new library is being referenced not as a new Library, but as a "Refurbishment". Well, it's a completely new \$2.1 million-dollar new, changed Library use, and it's not a supermarket being refurbished.

It also came to light in the operational Plan Quarter 2 (September to December 2021) report that Council had received four concept plans from the architect and that they were going to be considered by Council in early February 2022. Well, we weren't told this and these other concepts were never shown to us or even mentioned.

I moved a motion that Councillors be shown these plans, and it was defeated in a 4/2 vote. The Mayor, Councillor Christensen, then moved an amendment to the motion that:

Council acknowledges that the Mayor has directed the CEO to make all "Grammatical and Minor Amendments" consistent with the clarifications provided in the meeting...

The resolution went on to pinpoint the "inconvenient" words by calling them "the third dot point on page 86 of the draft operational plan quarter two progress report"

The actual words that were referred to were under the heading "Libraries" of Page 89 of the Ordinary meeting agenda and reads:-

"Four concept designs have been developed for the new Tamborine Mountain Library Space. These plans will be presented to the Councillors and Executive team to select the final design early in 2022."

Well, we never saw them, and it is apparent that they didn't want the elected Councillors interfering with their plans. Is Council acting in our best interest? Now the answer is to authorise the CEO to modify the inconvenient words! You be the judge.

On another matter, I thank the person who wrote to me in appreciation for reiterating in my last column the extract from the Council's new Customer Charter:

1. We'll acknowledge you and listen to your needs.
2. We'll follow through and act in the community interest always.
3. We'll be open and honest always.
4. We want to be loved by the Community. You're the ultimate reason we are here. It's important to us that you love the work we do, and that you love dealing with us.

JUDITH WRIGHT BOARDWALK IN DISREPAIR.

This is a major asset on Tamborine Mountain for locals and tourists. I recently did an inspection of this boardwalk on Eagle Heights Road, starting from the Anglican Church corner towards Gallery Walk. I was quite shocked it has fallen into such disrepair. Council prides itself and boasts about its asset management plans that are designed to see that our assets are renewed, and maintenance is kept up to date. Somehow, they don't seem to be working for Tamborine Mountain in this instance, and don't get me started on the state of our roads. I hear you loud and clear! I have requested that urgent work be done on this asset before it is beyond repair. *Photos on page 4 (opposite left)*

STAFFSMITH PARK NEW TOILET BLOCK, REGRETTABLY, IS ANOTHER FAILURE.

Councillors are constantly reminded we are not to be involved in operations, but when basic and simple operational tasks are carried out to the detriment rather than benefit of ratepayers, I must question this philosophy that seems to suggest Councillors don't need to be consulted.

I was not consulted on any aspect of the new toilet block on Staffsmith Park. Now we are left with about 25% OF THE PARK PLAY AREA BEING unusable, simply because of the new transpiration areas reaching into the playing area and which have permanent bollards concreted into the ground about five steps from the cricket pitch.

I have talked to old timers who remembered when fixtures were played on these grounds going back 100 years, and others recall half a century ago to the present, when visitors to the park enjoyed playing family cricket on this oval. Now, all that is gone, because your elected representative wasn't consulted. Surely common sense would suggest a problem.

Photos on page 4 (opposite left)

CEO CONTRACT RENEWAL SAGA FINALLY RESOLVED

The minutes of the Special Meeting of Council dated 3rd February 2022, which ended on the 17th of February, show that the CEO saga finally came to a conclusion with assistance at the re-adjourned meeting of 17th February from Department of Local Government Senior Officers and the Managing Partner from King and Company Solicitors. Never in my career have I seen a process as poor as this which altogether dragged on from September 2021 and was an attempt to reverse a majority decision of Council to not reappoint the present CEO when his contract finished. You can find these meeting minutes online or request help from me to access them, and you can be the judge of the behaviour of many of your elected leaders in our community.

The CEO's last day with Scenic Rim Council is resolved as the 22nd of August 2022.

**Derek Swanborough
Councillor. Division 1
derek.s@scenicrim.qld.gov.au
Ph 0436 351 567**

TAMBORINE MOUNTAIN BRIDGE CLUB RESULTS

Wed 2nd N/S Max Irvine-Brown - Tony Hall
 E/W Marian Gibbons - Sheila Irvine-Brown
 Thur 3rd N/S Heike Edrich - Carole Cooke
 E/W Eddie Heinemeyer - Robert McCathie

MEALS ON WHEELS ROSTER – APRIL 2022

1st Keith ATTWOOD, Pam FRANKLIN
 8th Athol & James MCDONALD,
 Tanya JOHNSTON-HIRD
 13th Harry O’NEILL, Stephen & Lauren FORBES
 22nd Glenys KELLY, Stephen NUSKE
 29th Deb GREENWOOD, Linda DUBBERLEY

MICHAEL DWYER Solicitor

A Name You Can Trust

For over 25 years, Michael Dwyer Solicitor, a Tamborine Mountain local, has served businesses and families in the Gold Coast area. Our firm also has the capacity to work interstate & internationally.

**Family Law, Conveyancing,
 Commerical Law, Criminal Law,
 Trusts, Wills and Estates**

Call Today! FREE First Consultation Offer

OFFICE HOURS
 (07) 5526 4572 • info@mdsolicitor.com.au

URGENT AFTER HOURS CONTACT
 0419 026 920 • michael@mdsolicitor.com.au

TAMBORINE MOUNTAIN RAINFALL

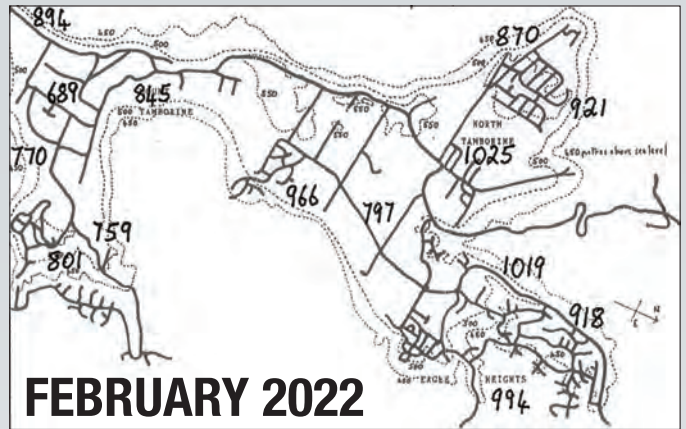

The Bureau of Meteorology told us we’d have a La Nina summer, and we certainly have in terms of rainfall. First, to records: With 689.1mm at Fern St for the month only three other years have had wetter Februarys – 1928 with 708mm (decimals rounded off); 1976 with 713mm and 1954 with 794mm. However this followed a very wet January. The combined total for the two months was 1057mm this year. This has been exceeded three times before also. In 1976 the combined total was 1116mm, in 1947 it was 1392mm and in 1947, the year of the big January flood, it was 1925mm.

The month started with a thunderstorm following a hot day and more than an inch of rain fell in about 40 minutes. More heat storms followed. Upper atmosphere lows produced more substantial falls, with a thunderstorm with some hail on the 18th. This was the precursor of a trough coming south down the coast and actually moving off land but, intensified by an upper atmosphere low, brought in increasing amounts of moisture over the days. It was then enhanced by a trough coming in from the west. This produced the very serious floods which ensued.

The map shows that there was substantially more rain at the northern end of the Mountain, some recorders getting more than a metre. These big falls were recorded by those people who conscientiously emptied their gauges the night of the 27th. Others, like yours truly, had their gauges overflowing by 0900 on the 28th!

Mike Russell 5545 3601



Scott BUCHHOLZ MP
 Federal Member for **Wright**

Working for Wright

- 21 William Street, Beaudesert QLD 4285
- 07 5541 0150
- scott.buchholz.mp@aph.gov.au
- scottbuchholz.com.au
- SBuchholzMP

Authorised by S. Buchholz, Liberal National Party of Queensland, 21 William Street, Beaudesert QLD 4285.

COMMONWEALTH FINANCIAL ASSISTANCE FOR COMMUNITIES IN WRIGHT ELECTORATE

Federal Member for Wright Scott Buchholz has announced financial assistance is available to residents in his electorate, impacted by the flooding disaster that has unfolded across the state.

The Australian Government has activated the Disaster Recovery Payment and the Disaster Recovery Allowance to support communities in the local government areas of Gold Coast, Ipswich, Lockyer Valley, Logan and the Scenic Rim.

Mr Buchholz said those affected residents can claim the Disaster Recovery Payment now and claims for Disaster Recovery Allowance available from Tuesday 1 March 2022.

"I have been monitoring this situation very closely and so has the Government through the National Situation Room, we have been making supporting available and stepping up our support each day.

"This really was a flood emergency that hit our community hard, and I am thinking of those people whose lives are affected.

"Sadly, we know too well the impacts of these events in our region. I have been speaking with our local leaders and providing that feedback to the Prime Minister, Minister for Emergency Management and Minister for Defence.

"The Commonwealth Government have made financial support available now because we know the economic and social impact of disasters like these are felt long after flood water recede and there will be some very tough, days weeks and months ahead," Mr Buchholz said.

The Disaster Recovery Payment is a one-off, non-means tested payment of \$1000 per eligible adult and \$400 per eligible child, and is available to eligible people in those affected local government areas who have suffered a significant loss, including a severely damaged or destroyed home or serious injury.

Disaster Recovery Allowance will also be provided in the same affected local government areas. DRA assists

employees and sole traders who experience a loss of income as a direct result of a major disaster. DRA is payable for a maximum of 13 weeks and is taxable.

Equivalent financial assistance will also be available to eligible New Zealand citizens ('non-protected' Special Category Visa, subclass 444 holders) affected by the storms and floods.

The easiest and quickest way to claim the Disaster Recovery Payment or the Disaster Recovery Allowance is online through myGov. If people require support to claim, they can call the Australian Government Emergency Information Line on 180 22 66,

To provide further support the Australian Government is also pausing Centrelink debt raising and new debt recovery in the affected locations.

Online claiming via MyGov is available 24x7. The Australian Government Emergency Information Line is open Monday to Friday, 8am to 5pm local time. For more information on support available, visit [servicessaustralia.gov.au/disaster](https://www.servicessaustralia.gov.au/disaster)

More information: www.servicessaustralia.gov.au/south-east-queensland-floods-february-2022-australian-government-disaster-recovery-payment



JOIN THE CONVERSATION - AND WIN GREAT LOCAL PRIZES - AS DEADLINE FOR COMMENT ON TWO CRUCIAL PROJECTS IS EXTENDED

Need an extra incentive to have your say about Council services and the future of the Scenic Rim?

Residents, businesses and community groups now have until Sunday 27 March to join the conversation around two important projects.

The **deadline** for feedback on both the Draft Growth Management Strategy 2041 and Council's Customer Satisfaction Survey have been extended by three weeks to **27 March**.

Even better, there are some great prizes up for grabs for participants who engage on the *Let's Talk Scenic Rim* platform during these consultation periods, including double passes to the Long Sunset Music Festival, and double passes to Culture Centre events, and copies of the popular Eat Local Cookbook.

Let's Talk Scenic Rim!

Council is keenly seeking local comment about the Draft Growth Management Strategy which outlines the scale, location and timing of future residential and employment growth in the region.

"Community input is absolutely vital to ensure future growth in the region is well-planned, reflective of community expectations and protective of our region's lifestyle for future generations," Mayor Greg Christensen said.

"We have received strong feedback on the growth management strategy, and we want to continue that

engagement, which is why we have decided to extend the opportunity for people to access the information and ask questions," he said.

The wide-ranging Customer Satisfaction Survey also seeks specific feedback on Council's key services including waste management, roads and footpaths, Council-owned facilities, lifestyle factors, communication and regulatory services.

"Community feedback through this survey will help us as a Council to determine if we are meeting community expectations and how we can ensure continuous improvement in the programs and services that we deliver to our community now and into the future," Cr Christensen said.

By registering and contributing to the conversation, your voice will be heard on the topics that matter. It will also put you in the running for some great prizes, including one of six double passes to The Long Sunset music festival, six double passes to Culture Centre events and six copies of the much-loved Eat Local Cookbook.

All *Let's Talk Scenic Rim* participants (current and new registrations) are eligible with the prize winners announced on 30 March.

Visit the *Let's Talk Scenic Rim* online portal www.letstalk.scenicrim.gov.au before Sunday 27 March, and have your say on these two exciting projects to go into the draw.



IF A CITY'S WATER IS STOLEN

WHO WILL STAND UP AND FIGHT?

QUEENSLAND GREENS CAMPAIGN LAUNCH AND FILM NIGHT

When: 27th of March 6pm

Where: Zamia Theatre, Main St, Tamborine Mt

An evening of community coming together.

Meet the Greens candidate, Nicole Thompson, enjoy some canapes, a critically acclaimed film and some uplifting conversation.

Into Dust tells the extraordinary true story of Perween Rahman, a woman who worked tirelessly to protect the rights of Pakistan's poor, and paid the ultimate price. Set against the backdrop of a global water crisis, Perween's story highlights the dangers of what can happen when our water starts to run out.

Scan to get your ticket or go to tinyurl.com/IntoDustFilm



Authorised by K Carra for The Greens, 52 Douglas Street Milton, Brisbane - AN 2022/0471

Through our extreme weather, the Scenic Rim community knows intimately that Climate Change is here.

As your Greens candidate for Wright, I'm here to listen to you and push for immediate effective action.

Like a lot of you, I'm so disappointed with Federal politics right now. We desperately need real action on climate change, mental health and political corruption. The Greens gaining the balance of power is the way to get it done!

We need more women in parliament with a range of life experiences. I'm a nurse, midwife, foster carer and have been the mother of a child with profound disabilities. The Queensland Greens' lead Senate candidate Penny Allman-Payne is a high school teacher in Gladstone, hears the needs of families every day. We are the only party that refuses corporate 'donations'. We always put people first. Our comprehensive, evidence-based plan for Australia will make everyday life for ordinary people better. Let's get more Greens in parliament and make it happen!

- Vote 1 - Penny Allman-Payne for the Senate so we don't get lumped with Clive Palmer
- Vote 1 - Nicole Thompson for the Lower House
- Volunteer for our campaign through the QR code on our ad
- Follow me and connect through Facebook or Instagram

Come say hi when you see me in the local community. I'd love to meet you and advocate for your concerns.

This time, vote Greens first!

Nicole Thompson
Greens for Wright



07 5545 2522



**Here is something to smile about:
Mention this ad, and your check-up,
clean and x-rays procedure
is only \$200 (limited time only).**

Tamborine Mountain Shopping Square
17-27 Main Western Road, North Tamborine
ehdcreception@eagleheightsdental.com.au
www.eagleheightsdental.com.au

ADVERTISEMENT

VOTE **1** GREENS



**YOUR TEAM
IN THE SENATE**

**NICOLE
THOMPSON
FOR WRIGHT**



Get Involved



greens.org.au/qld/plan

A FUTURE FOR ALL OF US



Authorised by K Carra for The Greens, 52 Douglas Street Milton, Brisbane. - AN 2022/0472



JON KRAUSE MP

State Member for Scenic Rim

SEVERE WEATHER IMPACT ON ROADS

The heavy rainfall event and severe storms that battered the Southeast last week highlighted once again the extraordinary efforts of our SES and Energex crews, as well as other emergency service personnel. I'd like to thank them for their hard work. Some people had water through their homes or businesses, and I have seen a terrific community mobilisation to assist people in need – especially where insurance may be an issue. There are plenty of potholes to be fixed on roads around the Mountain (I was there on Wednesday last week, and again around Tamborine and Mundoolun on Sunday to see for myself). The near \$6 billion backlog in road repairs and maintenance that has arisen under this QLD Government is making things worse - things start to crumble quicker and in a bigger way when they haven't been looked after properly, and so it is right now across our region.

These recent weather events also highlight why the Howard Creek Crossing upgrade is important. This \$10 million project is 80% funded by the Federal Government and Member for Wright, Scott Buchholz and I have been fighting for these works to be completed. I received an update last week from Main Roads after making representations on behalf of concerned constituents in relation to traffic management at road works on Tamborine-Oxenford Road. Main Roads advised that works are currently underway at Wongawallan, including short term pavement reseal activities at various locations including near Welches Road. Variable message signs are in place, providing advance warning at all work sites and speed is reduced to 40 km/h. Most importantly locals should note that the Howard Creek project traffic in the work zone will soon be reduced to one lane, 24-hours a day, seven days a week for approximately four months.

All this rain impacts works on the Goat Track (Tamborine Mountain Road). It is a project being carried out in extremely difficult and dangerous conditions – even without rain – because of the slope and very rocky surface. Keeping all people working there safe is a major concern, and unfortunately the weather will likely see even further delays on its completion. When I have a firm update from Main Roads, I will provide it.

OVERSEAS EVENTS

I know events in Ukraine have shocked many Australians. Particularly on Tamborine Mountain, there are quite a few residents who have moved to Australia from Europe, some even arriving in the early years after World War II – these events must be harrowing to watch. Australia must prepare for what could be tumultuous years ahead globally and the impacts it could bring to our economy, including by ensuring that essential services and manufacturing can be carried out here. Affordable, reliable energy is key to that, as is the need to unleash the potential of our businesses who want to grow by reducing the red-tape barriers put in front of them. Every day of economic enterprise and growth lost – and in our region that's from small and family business - is a lost opportunity for Australia. All levels of government should be committing to bringing down these barriers – not in a reckless, irresponsible way that damages the environment or leads to silly development, but with an acknowledgement of the challenges faced by business, the costs to our country in terms of jobs and productivity lost, together with an ongoing commitment to bring down those walls that prevent growth.

To contact my office, call 1800 813 960 or email scenicrim@parliament.qld.gov.au

ADVERTISEMENT



Jon KRAUSE MP
Member for **Scenic Rim**

Fighting for our fair share

☎ 07 5515 1100 f JonKrauseMP

Authorised by J.Krause, 91 Brisbane Street, Beaudesert QLD 4285.



SCOTT BUCHHOLZ

Federal Member for Wright

DISASTER ASSISTANCE ACTIVATED FOR FLOOD AFFECTED COMMUNITIES

In response to major flooding events sweeping across Australia's east coast, the Prime Minister and Minister for Emergency Management and National Recovery and Resilience, Bridget McKenzie, announced disaster assistance is now available for flood affected communities. Residents in 38 flood affected local government areas across Queensland and New South Wales can now apply for Commonwealth financial support through Services Australia.

The Australian Government Disaster Recovery Payment (AGDRP) provides for \$1,000 per eligible adult and \$400 per eligible child. Disaster Recovery Allowance, a short-term income support payment, is also available. Over 69,000 claims, totalling more than \$83 million, have already been finalised. Primary producers in NSW can register for recovery grants of up to \$75,000 and small businesses up to \$50,000.

Around 2,000 ADF personnel have been deployed to support affected communities to deal with the floods and support clean up work. 11 ADF aircraft are providing support with 54 missions completed, rescuing 103 residents as of Friday morning.

Further information on how to access the payment can be found on the Services Australia website.

AUSTRALIAN SUPPORT FOR THE PEOPLE OF UKRAINE

The Australian Government has committed significant military and humanitarian assistance to support the Ukrainian people as they seek to repel the brutal Russian invasion. Australia will provide around \$70 million in lethal and non-lethal military assistance, including missiles and weapons, and a range of other military equipment and medical supplies in response to a specific request from the Ukrainian Government.

Australia will also send life saving humanitarian assistance of an initial \$35 million to help meet the urgent needs, including for water, shelter and medical supplies. The Prime Minister this week reaffirmed Australian solidarity with the people of Ukraine and said Australia stands ready to provide further assistance should it be requested.

Earlier in the week, the Prime Minister announced a series of targeted financial sanctions and travel bans, targeting the Russian President and permanent members of Russia's Security Council. So far Australia has sanctioned more than 350 Russian individuals, including corrupt oligarchs, MPs, and military commanders. Australia will continue to work with allies and like-minded countries to impose further economic sanctions on Russia.

BACKING THE NEXT GENERATION HYDROGEN FUEL STATIONS

The Morrison Government is boosting its support for the uptake of heavy hydrogen fuel cell electric vehicles. The Australian Renewable Energy Agency (ARENA) is providing \$22.8 million to fund the construction of Australia's first public New Energies Service Station in Geelong. The Viva Energy hydrogen cell refuelling station will support a range of technologies, including electric vehicle battery recharging and traditional diesel refuelling infrastructure. Minister for Industry, Energy and Emissions Reduction Angus Taylor said construction of the hydrogen fuel station forms part of the government's strong commitment to reduce emissions in the transport sector through low emissions technologies.

NEW PBS LISTINGS FROM 1 MARCH 2022

Australians will have access to four new medicines through the Pharmaceutical Benefits Scheme (PBS) from March 1. The new listings include an oral anti-viral medicine, Lagevrio, for Australians at highest risk of developing severe COVID-19. This is the first COVID-19 medicine to be listed on the PBS. Ultomiris will be listed for the first time for patients with paroxysmal nocturnal haemoglobinuria (PNH), a condition that produces defective blood cells, benefiting around 160 Australians a year, who may otherwise pay around \$550,000 per year for treatment. The listing of Uvadex will support Australians with chronic graft versus host disease. Mylotarg is also being listed for Australians with acute myeloid leukaemia (AML), a rare cancer of the blood and bone marrow.



Letters to the Editor

SHELVING RESPONSIBILITY NO LONGER

Now that there has been a catastrophic collapse on the Shelf Road on Tamborine Mountain, it is incumbent on the Scenic Rim Regional Council's planning department to actually view this disaster for themselves. It might give them some idea of possible dire consequences arising from inappropriate development approvals.

The whole shelf area is a known severe geological slippage area and yet through what I can describe only as skulduggery or chicanery, council approvals were obtained in the past by a developer who completely disregarded professional engineering advice. The ramifications have been enormous. If I were among the current owners along The Shelf Road I would be exploring legal avenues to obtain some redress from local authorities. To the planning department I say, ignore the planning scheme at your peril.

Roland Lindenmayer

THE ELEPHANT IN THE ROOM - FUTURE GROWTH

If there is a need to evacuate the mountain in a hurry, eg massive bushfire, it will be a disaster. The mountain has very few access roads (some of which would probably be unusable).

The nature of existing development has created 'enclaves' with one road exits. E.g. golf course area, Forest Park, Licuala Drive, Main Street and numerous smaller offshoots. Other areas, whilst having more than one exit road, would have the same problem of residents in the above areas of just getting onto a major exit road.

Look at the problems now of getting out of Beacon Road during school hours. Then add a general evacuation, and imagine the chaos. The main roads would already be full of traffic from further afield. The feeder roads would be at a standstill.

In an emergency, you would need police control at all these feeder roads. Unlikely, as they would probably be engaged in assisting/directing evacuations from homes or assisting with the actual emergency.

The firies at their public meetings a few years ago said they could envisage some time in the future when the mountain would need to be evacuated. My enquiries did not indicate any planning to achieve this.

Why approve increased population on the mountain in these circumstances? It is a recipe for disaster, and the relevant authorities should acknowledge this.

Harvey Ruglen



Shelf Road update:

Contractors were on site on March 2 at The Shelf Road to reinstate temporary access for residents.

These works were to allow access to remain in place while further investigations are carried out by geotechnical engineers to "assess the structural integrity of the road, before developing a works plan for a more permanent solution."

Proudly maintaining the smiles of the Tamborine Mountain Community for over 25 years!



FAMILY & COSMETIC DENTISTRY

- We offer a comprehensive dental service covering all areas of dentistry.
- Preferred providers for BUPA, Medibank Private, CBHS & HCF.

PHONE: 5545 2788

MOBILE: 0455 452 738

info@tamborinemountaindental.com.au

www.tamborinemountaindental.com.au

OUR TEAM:

Dr SANDEEP GUPTA B.D.Sc

Dr Eyk Schiller B.D.Sc



TAMBORINE MOUNTAIN DENTAL

EAGLE HEIGHTS SHOPPING VILLAGE (above FOODWORKS) 14/17 SOUTHPORT AVE, EAGLE HEIGHTS



**TAMBORINE MOUNTAIN
MEDICAL PRACTICE**

14 Main Western Road
North Tamborine
and
Shop 1/17 Southport Avenue
Eagle Heights

Phone: 07 5545 1222

www.tamborinemountainmedical.com.au
online booking service available on this website

50 years of continuous service to the
Tamborine Mountain community

Affiliated with three universities

**COMPREHENSIVE
HEALTH CARE
SERVICE**

Opening Hours:

Mon – Thurs 8.30 am – 6:15 pm
Fri 8.30 am – 5 pm
Sat 8.30 am – 12 noon
Sun 8.30 am – 10.30 am
(Sundays are Telehealth only)

Dr Ann Bennett
Dr Leeann Carr-Brown
Dr Jan Zomerdijk
Dr Sanne Kreijkamp-Kaspers
Dr Henri Coombs
Dr Cobie Powell
Dr Hok-Yee Siu
Dr Marije Dalebout
Dr Iqbal Meeran



Accredited by
 Quality Practice
Accreditation

SUPPORT FOR FLOOD-AFFECTED RESIDENTS AND BUSINESSES

Local residents impacted by floods are encouraged to contact Council for information to access support to help recovery.

LDMG Chair Mayor Greg Christensen said he encourages all residents and businesses to reach out to Council for support.

"It's a bit of a stereotype that people from rural areas just get on with it and while that may be true, we need all locals impacted by this weather event to alert Council," he said.

"We ask you to call Council on 07 5540 5111 to advise of any impacted residences and businesses from across the region, so we can take your details and help you access support information available to you.

"Not only this, but it's vital Council and emergency agency partners have a full picture of the scale of this weather event not only to manage recovery efforts, but also take learnings for future disasters.

"Council has also created a webpage with information on various support avenues, grants and more which are available to impacted residents and businesses. You can view this page at www.scenicrim.qld.gov.au/disaster-management/support-flood-affected-residents-businesses

"I again want to take this opportunity to thank our incredible emergency services, employees, Community Disaster Volunteers and all businesses and members of the community who have come together to work through this event.

"For any locals looking to pitch in and help recovery efforts, please head to Volunteer Queensland's website at www.volunteeringqld.org.au or phone 07 3002 7600 to get connected to local recovery projects.

"Please remain vigilant of dangerous conditions around the region, check roads on the Disaster Dashboard if you must travel, and stay out of floodwaters."

All local residents impacted by floods are asked to contact Council via 07 5540 5111 or visit www.scenicrim.qld.gov.au/contact-us



CHEF AND KITCHEN HAND REQUIRED FULL TIME OR PART TIME



101 Alpine Tce Mt Tamborine Q 4272

- Very Attractive Wages
- Award Conditions
- 38 hour week (or part time)
- Lieu day off for PH's worked
- Must be available most weekends
- New Kitchen and Team environment

Help make a difference!

**Email: accounts@stbernardshotel.com
or Ph 0418 717 558**

LET TMO BE YOUR GUIDE: KICKING OFF THE SEASON

The 2022 season for the Tamborine Mountain Orchestra kicks off on March 26 at 2.30pm. We invite you to join the TMO in *A Musical Journey Around the World*.

We'll travel from Egypt with Verdi's *Grand March from Aida*, to India with the haunting beauty of Rimsky-Korsakov's *A Song of India*. Things will get spicy with some Mexican Tijuana Brass. We'll pop into Ireland with some tunes from the 1916 uprising. You can even tap your toes along to an Irish Reel and some Slavonic Dances.

Regulars to our concerts may notice that we're a bit bigger, and we think sounding better than ever too. It's great to see the number of adults from the community and students from both TMSHS and TMC that have come along and joined our small community orchestra this year.

Tickets are \$10 for adults and children are free, and are available through www.ticketebo.com.au/tmo.

The TMO greatly appreciates the assistance of TMSHS, and the principal Mrs Brose, for the use of their wonderful auditorium for our concerts and rehearsals. We also thank our sponsors: Cauldron Distillery, Leaf Japanese Restaurant, Tamborine Mountain Medical Practice, and the generous support of the Scenic Rim Regional Council.

We're looking forward to playing a great selection of music, and hope to see you there!

Sean Donnelly

ON THIS DAY MARCH 10

1876 In the first telephone call, Alexander Graham Bell says to his assistant Thomas Watson: "Mr. Watson, come here, I want to see you."



TAMBORINE MOUNTAIN ORCHESTRA

Presents



A Musical Journey Around The World

Saturday 26 March 2:30

Tamborine Mountain State High School

TICKETS @ TICKETEBO.COM.AU/TMO
Adults \$10 / Children free



Proudly sponsored by:



Generously supported by SRRC



WHAT IS NEUROGRAPHIC ART?

Remember the days when ‘doodling’ in the school notebook covered more page space than the notes themselves and yet the learning process was engaged? Here’s a doodler’s upgraded version gaining in popularity, available to individuals or social groups at no big expense.

Neurographic Art is a way to work with the subconscious mind through drawing. This creative method stimulates new neural pathways by combining art and psychology. Simply stated, connected neurons process information received, enabling people to interact, experience emotions and sensations, create memories, and enable learning. This art technique is intended to transform one’s stress and fear into a beautiful work of creative expression, by drawing freeform lines, then later applying a specific algorithm.



TMCCA’s Friday Friendship Group enjoys once-a-month, art-therapy sessions with Polly Cameron. Thank you, Polly, for guiding us through this! Participants threw themselves into this activity and thoroughly enjoyed the Neurographic Art session last week! Polly affixed each one’s neurographic art onto a little notebook for future use!

For those who aren’t doodlers, this activity could be just another way to enjoy some artistic ‘me-time’ or a creative session with friends.

The algorithm is simple:

- Use a felt tip pen to draw imperfect circles or ovals on your paper.
- Draw long looping or crisscrossing/ scribble-like lines to cut across the circular shapes
- If you want to do the art therapy - think of an issue you are facing while you draw the line. Don’t try to draw something intentionally... just doodle away
- Fill in any sharp corners where lines intersect by ‘rounding off’.
- Add colour (blend colours or just shade in).
- Give it a go and enjoy!



Patricia Arora
(TMCCA)

Relationships



THE IMPACT OF DISASTER

The past couple of weeks have been traumatic for many people. Overseas there is war and locally we have endured yet another flood; all this on the heels of two years in a pandemic and some of the worst bushfires Australia has experienced. Understandably, all these events can be overwhelming. Media continually shows the worst tragedies, while our news feeds are flooded with cynical stories and comments.

Disaster Studies is a field of research that emerged after WW2. In the decades since, researchers have conducted field studies on the impact of disasters on societies. The results are surprising. While short term effects include anxiety, shock and anger, the long-term effects have consistently been post-traumatic growth, resilience, increased altruism, and engagement with community.

Disaster can bring out the worst in people. We hear reports of looting and panic buying. But the worst is more the exception than the rule. Time and again, individuals and communities come together in small gestures of compassion and connection that show who they are, how they want to live and what matters to them. The ‘mud

army’ rises out of Queensland floodwaters whenever needed. Our courageous SES volunteers put themselves in the most dangerous situations- whether fire or flood- to ensure others stay safe.



I was heartened to watch media covering the Ukraine/ Poland border where volunteers in their hundreds were providing meals, clothing, toiletries and transport to Ukrainians fleeing the war zone. Many held up destination signs. A young man from Berlin was interviewed. He makes the 20-hour round trip to the border every day he doesn’t work- taking up to four refugees back with him. “I cannot join the war, but I can offer this small act” he said.

These impromptu, spontaneous, bottom-up responses demonstrate that in moments of darkness there are countless moments of light. Charles Fritz, regarded as a giant of modern disaster studies says, “The merging of individual and societal needs during a disaster, provides a feeling of belonging and a sense of unity rarely achieved under normal circumstances.” Seven hundred studies on natural disasters confirm this same result. The vast majority of people stay calm and help each other. “Whatever the extent of the looting,” one sociologist notes, “it always pales in significance to the widespread altruism that leads to free and massive giving and sharing of goods and services.”

When listening to media or reading news feeds, keep in mind that you are only hearing part of the story. There is a back story of unsung heroes, ordinary people doing extraordinary things, coming to the aid of strangers. Those in desperate need, have their faith in humanity rekindled. Their actions serve as a reminder that even though the world is large, one person can still make a world of difference. Let troubled times bring out the best in you.

Linda Gray
linda@relationshipsanctuary.com.au
0401 517 243



John Bestevaar

John Bestevaar

“If you’re stubborn enough, then you can live a long time independently”, says John Bestevaar when editor Jaap Vogel asks him about his challenges to live alone, having a very severe disease.

“Emphysema is a terrible, disabling disease. But even here on Tamborine Mountain it is well possible to live with it, even though we don’t have a hospital. Support by Meals on Wheels and Community Care really help me to live much longer by myself. And in case crisis strikes, we have a good ambulance network. In addition, supported living is no option for me because I cannot afford to contribute to the costs of that. I also would really be struggling with the restrictions you have to deal with. I’m a very free spirit, as well as, at times, a pain in the neck.”

After coming to the mountain as a tourist, then Brisbane resident John decided three decades ago to move, and he has not had one second of regret. “It is a magical place, with the forests, the ambience, the people, the laid-back

lifestyle and the natural environment. I continued my business in creating fibre glass and polystyrene from the shed on my Licuala Drive property. When Elizabeth Russell called for Landcare-volunteers in the local newspaper, I stepped up because the Esme Street Environmental Park project was a stone’s throw away from my house”.

“That forest was covered in blue morning glory, and I was familiar with the ways to eradicate it, with a low dosage 2.4-D. Two years later the project was finished, and it still looks awesome nowadays. I joined both Landcare and the Bush volunteers and these organisations clearly have kept me busy in the past twenty years. But it is necessary always to consider what volunteer groups should and should not do. It is a great thing that the community is actively involved in maintaining the public parks. But, as our previous environmental officer, the late Doug White, used to say: “Landcare is the cheapest department of Council”. Nevertheless, I have always been happy to be involved but because of my health, those years are over.”

PUBLIC HEALTH ALERT – CONFIRMED HUMAN CASE OF JAPANESE ENCEPHALITIS VIRUS

A public health alert is being issued following a confirmed human case of Japanese Encephalitis Virus (JEV) in Queensland.

The confirmed case had recent travel in regional southern Queensland and is currently being treated in a Brisbane hospital.

JEV is spread through the bite of an infected mosquito to people and animals. In animals, it mostly occurs in pigs and horses.

Clinicians at Queensland hospitals have been asked to be alert to the possibility of JEV in people presenting with encephalitis or a similar illness.

Most human infections of JEV cause no symptoms or mild symptoms such as headache or fever. A person with severe disease may present with inflammation of the brain (encephalitis), characterised by sudden onset of vomiting, high fever and chills, severe headache, sensitivity to light, neck stiffness and nausea/vomiting.

Children aged under five years of age and older people who are infected with JEV are at a higher risk of developing more severe illness.

We encourage Queenslanders to take necessary steps to prevent being bitten by mosquitoes, especially given the recent flooding event which may lead to an increase in mosquito numbers in coming weeks.

Measures to prevent mosquito bites include regularly applying insect repellent containing Diethyl Toluamide (DEET), Picaridin, or oil of lemon

eucalyptus; wearing loose, light-coloured clothing to cover up arms, legs and feet; and using other insecticide-based mosquito control devices where possible when outside.

Mosquito bites can be experienced at any time of day, but some species are most active at dusk and dawn.

Around your home, it’s important to inspect for common mosquito breeding sites, clean up debris and make sure to empty, wipe out and store any outdoor containers in a dry place.

It’s also important to ensure flyscreens are in good order so mosquitoes can’t enter your home easily.

Japanese Encephalitis Virus (JEV) is a nationally notifiable disease in both humans and animals.

The human case follows a detection at a piggery in southern Queensland last week. There have also been detections in New South Wales, Victoria and South Australia.

There is no risk to humans from consuming pork or pig products. Pork products are safe to eat.

The virus cannot be spread directly from person to person.

Queensland Health is working collaboratively with the Department of Agriculture and Fisheries and industry, as well as state, territory and national counterparts to discuss a national response.

Pethers Rainforest Restaurant

Intimate, romantic dining experience

Open Monday, Tuesday, Thursday to Saturday evenings – quiet, private and very intimate setting, ideal for couples.
28B Geissmann Street
(07) 5545 4577



1



Tamborine Mountain Distillery

Over 300 international awards

Australia's most internationally-awarded distillery and liquor brand in the New Millennium. Manufacturers of vodkas, liqueurs, schnapps, eaux-de-vie. 10am to 5pm – 7 days per week
10 Macdonnell Road (07) 5545 3452



2



Tamborine Mountain Pizzas

Dine-in, Takeaway, Delivery

Established in 1994, enjoy our signature dough prepared daily on site topped with a variety of fresh ingredients, many locally sourced.
4/11 Main Street
(07) 5545 3888



3



Tamborine Mountain Pasta

TAKE AWAY

OPEN 7 days:
11.30am – 2.30 pm lunch
5pm – 8pm dinner
Shop 1A/15 Main Street
(07) 5545 3795



13



The Polish Place

Polish Restaurant. Cottages. Gallery. Coffee. Vodka. A true Polish Experience
With 180° views overlooking the Great Dividing Range, it's the ideal location to experience luxury accommodation, scrumptious Polish cuisine, beers and vodkas
www.polishplace.com.au
333 Main Western Rd, 5545 1603



4



Fox and Hounds Country Inn

Gold Coast's only Authentic English Pub

Share a hearty dining experience with friends and family, while soaking up the spectacular surrounds. Open for lunch and dinner 7 days.
7 Elevation Drive, Wongawallan
(07) 5665 7582



6



Rainforest Restaurant & Lounge Bar

Dining within a tranquil rainforest setting!

"Loved the atmosphere and the service was very warm and friendly. The food was beyond great and we would love to come back every night if we could. Fantastic."
Brad C. – The Fork
Thunderbird Park, cnr Cedar Creek Falls Rd 07 5545 7990



5



Witches Falls Winery & Cellar Door

Tamborine Mountain's only working winery

Wines that shine with individuality and confidence. Enjoy wine tasting in our relaxed and picturesque setting. Locals receive members pricing. Open daily 10am to 4pm weekdays and 10am to 5pm weekends.
79 Main Western Road
(07) 5545 2609



8



Three Little Pigs

Bistro and Bar

Fine food and fabulous wine. Perfect place for relaxing and catching up with friends and family, or as a special treat.
13 Main Street
Nth Tamborine 07 5545 4484



7



St Bernards Hotel

Idyllic location with sweeping views, spectacular, fine dining for every occasion. Perfect for weddings, functions, conferences. Come and be greeted by our two St Bernards, and enjoy real country hospitality!
101 Alpine Terrace – 07 5545 1177



10



Club Tamborine

Visitors welcome

Your local on the Mountain: Full bar, Bistro, Gaming, Ubet, Keno, Fox Sports, regular live entertainment and bowls in a relaxed environment.
6-12 Beacon Road
(07) 5545 1308



9



Spare Part Solutions

Parts plus expert, personalised advice

We can supply parts for Automotive, 4x4, trucks & earthmoving, motorbikes, bicycles, general engineering, mowers, small machinery and more.
24 Main Street 07 5545 1988



12



Cauldron Estate & Distillery

Distillery – Vineyard – Bar – Events

Beautiful established vineyards and lush green meadows perfect for picnics, lawn games or kicking back for an afternoon of R&R. Enjoy our locally made spirits or drinks from the Cauldron Bar, relish our mountain-inspired 'Bar tucker' and picnic hampers, and even make your own bottle of gin in our distillery to take home.
89-123 Hartley Road, Tamborine Mountain Qld 4272
CauldronDistillery.com.au



14



El Burro Cantina

Come for the warmth, laughter and great MEXICAN FOOD!
• Fully licensed • Great for parties!
• Takeaway available

Flame Tree Plaza
16-20 Main Western Rd
North Tamborine 07 5545 4003



11



LOCAL DINING, SHOPPING AND SERVICES

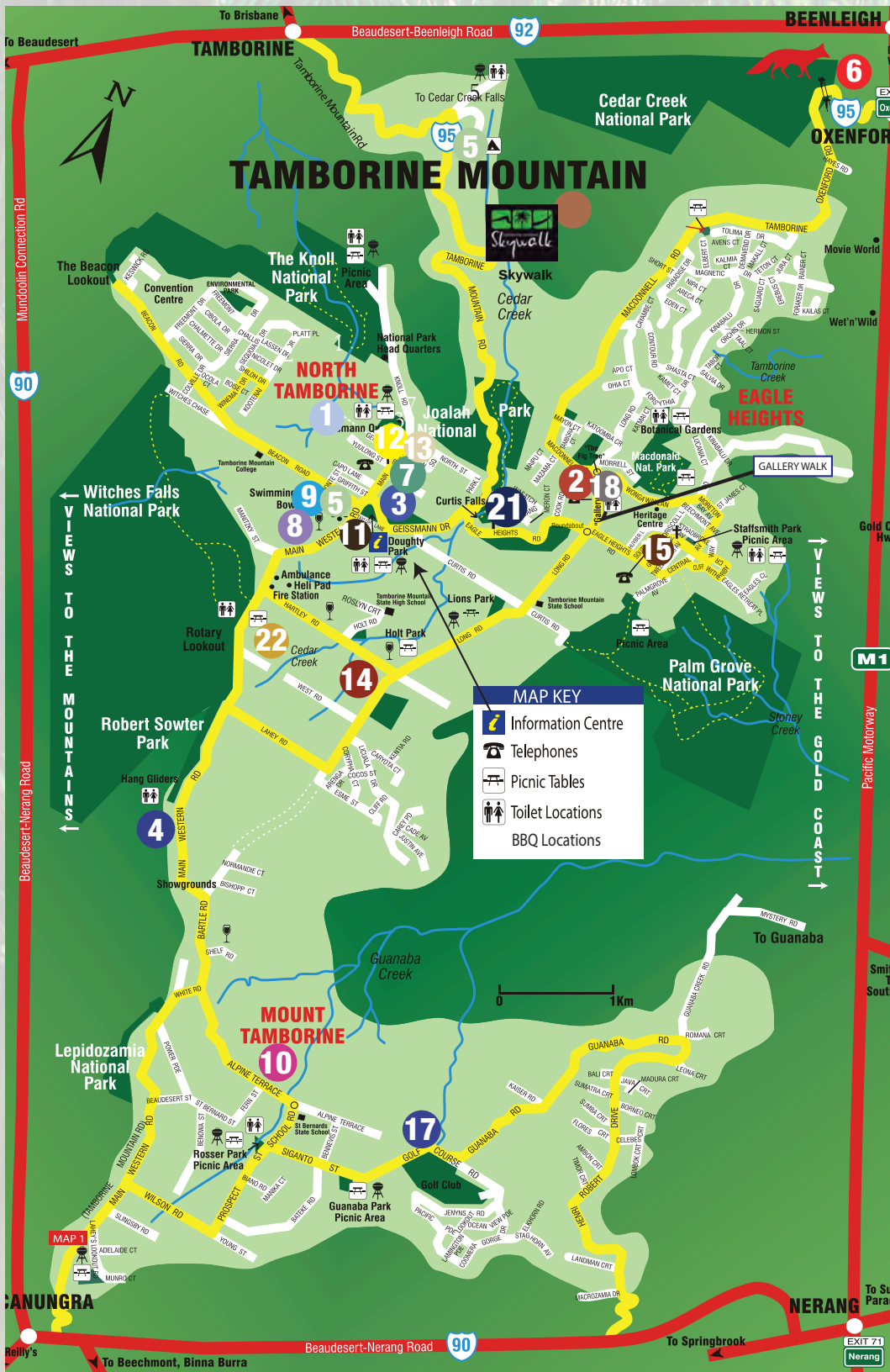

Getaway Day Spa Tambores Mountain

Open 5 Days

Monday, Tuesday,
Thursday – Saturday

Treatments available 9am – 5pm
Spa only available 5pm – 8pm

16 West Rd,
Tambores Mountain

07 5545 4751 **22**

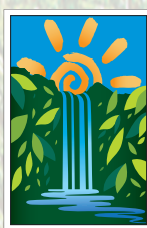

Escape to TAMBORINE MOUNTAIN

your Gold Coast Hinterland

EAGLE HEIGHTS BAKERY

25 Southport Ave, Eagle Heights



Open 7 days - 9.30-5pm
(including public holidays)
14 year-old sourdough,
30 different breads & flours

5545 4011

Serving the community for 40 years

GOLF HEAVEN IN THE HINTERLAND Amazing location

Situated 500m above sea level,
overlooking the Gold Coast, this
acclaimed 9 hole, 18 tee golf
course is a delight to play any
time of the year.

ENJOY THE MOUNTAIN EXPERIENCE

5 Coomera Gorge Drive
Tambores Mountain QLD 4272 07 5545 1788



17



GERMAN
CUCKOO CLOCK
NEST

NEW! HOWARD MILLER

- Contemporary Grandfather clocks
- Modern wall clocks
- Trusted Brand since 1926

OPEN 7 DAYS 10AM - 4PM

143 Long Road, Tambores Mountain
Ph: (07) 5545 1334 • info@clocks.com.au
www.clocks.com.au

MIND THE... AAARGH!



Andrew Wright, CEO and Artistic Director at Goat Track Theatre Company, takes a lighthearted look at the blighted roadscape of Tamborine Mountain with this 'Pothole Portrait' series, showing his many faces navigating – and failing to navigate – potholes on the way to and from work.



One of the larger obstacles presented to those trying to navigate the Mountain in recent weeks: this spectacular example on Beacon Road (opposite Winema Drive) joined similar collapses on Long Road, Geissmann Drive and numerous instances on Main Western Road, including possibly the Mountain's busiest stretch of road in front of the service station.

Whether the responsibility ultimately lies with Scenic Rim Regional Council or with Main Roads, the point is that each repair effort is a bandaid, quick and dirty patch job, rather than a serious, technically sound repair.

Residents are weary of watching money being poured into (and wasted) on patching the same potholes, time after time, after each major rain event.

Mountain ratepayers deserve better.

Living with DOGS



WA'S FIRST JUSTICE FACILITY DOG STARTS WORK AT PERTH CHILDREN'S COURT



Winston the five-year-old Labrador trained by Guide Dogs WA to interact gently and calmly with victims, witnesses and other court users to help reduce stress and anxiety when in the courthouse. The president of the Children's Court of WA, His Honour Judge Hylton Quail is very supportive of the program, stating that young people involved in the criminal justice system are particularly vulnerable because many have experienced disadvantage and trauma.

Winston started work 2-3 days a week in late September 2021 as part of a 12-month pilot program to assess the viability of extending the service. The Justice Director General said facility dogs are used in a range of legal settings, in Australia and internationally, and they have been highly successful in reducing anxiety in people interacting with the justice system. These positive effects also increase engagement with court proceedings and improves efficiency.

Some victims describe the experience of giving evidence in court as distressing and often akin to the offence itself in terms of traumatising. These stressors can significantly impact a person's memory and ability to concentrate and communicate.

Winston and his handler operate in the public waiting areas of the courthouse, they do not enter the courtroom or remote witness facility while court is in session. People can touch, pat and interact with the dog if they choose, Winston is trained to provide comfort by placing his head on their lap or lying on their feet. The dog and handler do not approach anyone without their consent and public signage informs court users of the dog's presence and advises them to inform staff if they are afraid of dogs or do not wish to be near one.

The pilot program will cost \$97,000 which will be managed by the Office of the Commissioner of Victims of Crime.

In the USA, a Courtroom facility dog began working in 1989 with great success, since then there are over 200 facility employed Courtroom dogs. They are also used in Drug and Mental Health Courts. France has started using dogs for Courtroom cases as well.

Pam Brandis,
Dip.Canine.Prac.

THE APPLETON LADIES' POTATO RACE

AUTHOR: Melanie Tait
DIRECTOR: Louise Haggerty

Inspired by real life events, **THE APPLETON LADIES' POTATO RACE** is a funny, honest and heart-warming story about upsetting the potato cart and standing up for your principles.



Zamia Theatre, Tamborine Mountain
March 25, 26, 27 April 1, 2, 3, 8, 9
7.30 Evening & 2pm Matinee
trybooking.com or TMLT website
Tables of 8 available.



Ian MacAllan
LAWYER

5545 4303

- Wills
- Probate
- Estates
- Enduring Power of Attorney
- Advanced Health Directives



40 Southport Ave Eagle Heights 4272

NOTICE OF ANNUAL GENERAL MEETING OF TAMBORINE MOUNTAIN BLUELIGHT ASSOCIATION

2PM MONDAY 21ST MARCH 2022

AT NORTH TAMBORINE POLICE STATION



TRAVELLING PLACES By Gina Storey

With Australia opening to the World, we have seen a flurry of bookings for travel overseas. One of the destinations gaining momentum is Canada. There are now direct flights operating out of Sydney with Air Canada with connections from Brisbane. However, what most people are opting for is flying via Auckland on Air New Zealand. Flights are several times a week and the service on board their modern fleet of aircraft is excellent.

The weather from May to late September is great for travelling and there are so many destinations on most people's bucket list that you could easily travel there for several weeks. On top of the list is often the Rocky Mountaineer Rail Journey that winds out of Vancouver along the plains before heading into the snow-capped Rocky Mountains. This wonderful train experience stops for an overnight in Kamloops before continuing on the next day, ensuring that you don't miss any of the spectacular scenery as you travel in daylight and also that you have a good night's sleep in a hotel bed!



Travelling along the roadway between Banff, Lake Louise and Jasper is breathtaking. Whether you are looking skyward to the peaks of the mountains, traversing wooded areas and keeping an eye out for brown bears, taking an icefield adventure on Athabasca Glacier or walking the trail around a powder soft blue coloured lake, this region is beautiful. Self-drive holidays are as popular as joining an escorted trip, however the limited accommodation in the region means all your arrangements need to be prebooked to ensure you have a bed for the night.

I remember driving up from Calgary to Banff – the road straight and clear and the sky and mountains seemed an endless vista. In the late 1800's Canadian Rail built fabulous hotels for their guests to stay in, these are now iconic hotels of choice. Banff Springs Hotel has an old-world charm that will enchant you. Chateau Lake Louise is modern and stylish – make sure to upgrade to a lake view room. Jasper Park Lodge is set in beautiful grounds with luxury log cabins – I even saw moose wandering through the golf course!

Combine the Rocky Mountains with an Alaska cruise – there are small expedition ships, cruise ships and luxury liners. Sailing up the Inside passage to the small townships of Sitka, Juneau, Skagway or Ketchikan. Meet the locals and learn about the region's history – the mining, salmon fisheries and the transfer of this rich wilderness from Russia to US hands. Take a small plane ride into the Arctic Circle ... an amazing world of tundra, polar bears, whales, and indigenous people.

If time allows, head east to the French speaking areas or Montreal and Quebec or further to the Atlantic coast and Anne of Green Gables country, Nova Scotia where they put a bib around your neck to eat lobster for dinner!

Canada is a wonderful country, diverse in its landscape and fascinating to visit. We are booking clients for travel later this year and through 2023.

Contact Travelling Places P: 075545 1600
E: travel@travellingplaces.com.au

WINE CHAT

with Witches Falls Winery

AUTUMN WINES

As February draws to a close, we can officially say summer is behind us. While we all hoped for a stress-free summer full of sunshine, this wasn't how things panned out. For many Tamborine locals, the reality of the year thus far has been a jumbled melange of rainy days, worrying headlines, isolation, and flood-warnings.



As we welcome Autumn, some days still feel hot and muggy – the threat of even more rain hanging thick in the atmosphere. On other days there's a definite chill in the air that catches us off-guard – can it really be March already? But looking around, there are several trees already starting to turn – green leaves fading softly into amber and yellow. The changing of the seasons is a great way to step back from the hubbub and take stock of the year thus far and check in with the world around us.

Autumn is a beautiful season and a welcome relief for those of us who can't tolerate the heat and humidity. When it comes to wine, there are some delicious grape varieties that embody the essence of this season. Read on for four recommendations on the best wines to drink this, Autumn.

- 1. Pinot Noir:** A light-bodied red, Pinot is the perfect wine to ease you into the idea of cooler months ahead. It's light enough to drink on warmer days (and can be chilled too) but definitely has an autumnal feel to it. Being a thin-skinned grape, Pinot Noir has delicate tannin structure. It's well-known for its earthy flavour profile, with some styles displaying aromas of forest floor and mushrooms alongside fruity primary notes of strawberries, raspberries, and cherries. Oaking adds further warmth, highlights the wine's earthiness, and may impart a hint of spice or vanilla too.
- 2. Touriga:** often called Touriga Nacional, has a little more body than Pinot. This thick-skinned grape creates a rich, smooth red wine with a resplendent purple colour. Originally a Portuguese varietal, there are many Australian vineyards that now cultivate Touriga. Aromatically divine, you may pick up on hints of violet, mint, or nutmeg on the nose, while the palate is juicy and fruit-forward. Think plump blueberries and sweet & sour cherries. Yum!
- 3. Tempranillo:** Not too light, not too heavy, this medium-bodied red wine reflects the in-between nature of the season. Tempranillo will warm you from the inside out with notes of jammy figs, smoky tobacco, and baking spices. If you ever come across a vineyard of Tempranillo grapes, come autumn-time, you'll discover the leaves of the grapevine turn a bright, vibrant red.
- 4. Arinto:** while red wine tends to increase in popularity come Autumn & Winter, there are many whites that also suit the season. Arinto is perfect for autumn because it's often barrel-aged in oak, adding depth and warmth to what is already a citrusy, moreish, refreshing white.

Cheers,

Alexandra Douglas
and the Witches Falls
Winery Team

GRILL MASTERS, FOOD LOVERS AND CAPTAINS OF FLAVOUR

CHEF DYLAN'S
Gourmet Food Co.

100% HAND MADE

GOURMET FOOD CO. GAUCHO
GOURMET FOOD CO. MEXICAN
GOURMET FOOD CO. CREOLE

www.gourmetfoodco.com.au

FOOD FOR THOUGHT

with Chef Dylan Gittoes

www.gourmetfoodco.com.au



MELT-IN-YOUR-MOUTH QUICHE LORRAINE

This classic French dish is famed for its simplicity and elegance. Crispy bacon with gooey cheese, soft silky egg surrounded by a crunchy base. Quiche Lorraine has it all. For me personally there is nothing better on a rainy day than the smell of buttery pastry cooking in the oven and that wonderful moment your fork cracks through the outer crust and hits the billowy centre. The hardest part is waiting for it to cool down before you're able to devour it!

This dish is great for any meal. I think it's perfect to serve as part of a grazing-style lunch but also an easy go to if you're planning a picnic due to the fact it also tastes great cold. Do yourself a favour and take an extra few minutes and go to the effort of making your own pastry. You won't regret it, especially if you own a food processor, as it's super easy. It's just some flour, butter, egg yolk, water, and hey presto: magically, a ball of soft dough ready for baking appears. Then simply rest, roll, prick and blind bake. Your kitchen will smell divine and what's more you'll now have the basics down for all sorts of savoury tarts.

Did you know? 'Quiche' originally derives from the German word 'Kuchen', which means cake. The French later put their spin on it and renamed the tart, Lorraine. This is because geographically, the Lorraine region hugs the border between France and Germany.

Whilst returning by bus to England from the Black Forest in the south of Germany via Paris, I was travelling on a night bus, and as usual we'd pulled into a large roadside petrol station to refuel. This stop was on the outskirts of a small city called Metz in France just over the border from Germany, in a region called Lorraine. I hear the familiar hiss of the front doors open "30 minuten" says the driver in his gruff voice with typical German efficiency. Like lemmings we all file down the aisle of the bus and head into the night. The cold air hits me like a slap in the face, my breath instantly becoming a fog. I shiver and pull up my hood stepping into the light rain, the warm glow from the service station beckoning us like moths to a flame.

Inside is a cafeteria like the ones you see at Ikea. I grab a plastic tray and place it on the rail that is designed to slide along as you pass each food item to choose from. First up is a grey watery soup with some sort of bread like dumplings floating on top. Pass. Next is some dry pasta lightly covered with what looks like tinned corned beef. Pass. Next is potatoes in a heavy buttery cream. Pass. Next I see there

is an empty tray and lastly is dessert, some fluorescent green and bright red jelly in plastic cups with cream on top. I gulp, disheartened. I can't eat any of that, can I? I think to myself. Then like an angel from heaven I see my saving grace. There heading towards the empty tray is an elderly lady in a hair net carrying a tray of what looks like freshly baked Quiche Lorraine! "Merci mademoiselle" I say cheekily as I grab two serves, which elicits a quick smile. I pay, and when I sit down to eat the flaky crust with soft cheesy goodness I'm suddenly full of gratitude, as I realise I had just found the diamond in the rough.

Chef Dylan tips: Chop the butter into cubes then place back into the fridge to harden up. Head to YouTube and watch a video on how to roll out pastry and place it into a tart base.

Serves 6
Prep 30mins
Cook time 1 hr.

Ingredients

For the pastry

- 175g plain flour
- 100g cold butter, cut into 1cm cubes
- 1 egg yolk
- 3 tbs very cold water

For the filling

- 200g bacon, cut into strips
- 125g gruyère or tasty cheesy
- 300 mls thickened cream
- 4 eggs
- 1 tbs Gaucho*

*Chef Dylan's Gourmet Food Co. Gaucho marinade

Method

1. For the dough, put 175g plain flour, 100g cold butter, cut into pieces, 1 egg yolk and 3 tsp cold water into a food processor. Using the pulse button, process until the dough just comes together. Take it out and pat into a disc sphere shape. Wrap in cling wrap and refrigerate for 1 hr.+
2. Place the dough onto a lightly floured bench top, then roll out about 1/2 cm thick. Make sure you don't let it stick to the bench top.
3. Line a 23 x 2.5cm loose-bottomed, fluted tart base, easing the pastry into the base.
4. Trim the pastry edges with a knife or scissors (save any trimmings) so it sits



slightly above the tin (1/2 cm so if it shrinks, it shouldn't now go below the level of the tin). Press the pastry into the flutes, lightly prick the base with a fork, then chill for 10 mins in the fridge.

5. Put a baking tray in the oven and heat oven to 200°C (fan forced).
6. Line pastry tin with foil, shiny side down, fill with ceramic pastry weights or dry beans and bake on the tray for 15 mins.
7. Remove foil and weights and bake for 4-5 mins more until the pastry is pale golden. If you notice any small holes or cracks, patch up with pastry trimmings.
8. While the pastry cooks, prepare the filling. Heat a small frying pan, cook the bacon crispy but not too crispy.
9. Cut three quarters of the 125g gruyère or tasty cheese into small cubes and finely grate the rest. Scatter the diced gruyère/ tasty cheese and fried bacon strips over the bottom of the pastry case.
10. In a bowl using a fork whisk in 4 eggs. Add cream and whisk to combine.
11. Gently pour three quarters of the filling into the pastry case.
12. Half-pull the oven shelf out and put the tart tin on the baking tray. Quickly pour the rest of the filling into the pastry case (you can fill it right to the top doing it this way).
13. Scatter the grated cheese over the top, and sprinkle on the Gaucho dry marinade seasoning then carefully push the shelf back into the oven.
14. Lower the oven to 190°C/fan. Bake for about 25 mins, or until golden and softly set (the centre should not feel too firm).
15. Let the quiche settle for 4-5 mins, then remove from the tin. Serve freshly baked or eat cold if there is any left over!



SCENIC RIM LIBRARIES WELCOME

BOOKCLUB

Your local library is the perfect place to join a book club. Read new titles, discuss viewpoints and potentially make new friends in the process.



Ask when your local book club meets by contacting us here at the library - 5540 5473

BABY RHYME TIME

A fun interactive session of songs, rhymes, books and movement to foster your child's love of language. Suitable for parents/caregivers with babies to children under three.



Fridays 9:15 - 10:00

To join this session please phone 55405473 or email the library - library.t@scenicrim.qld.com.au

BorrowBox

Borrow, download and enjoy the greatest Australian and international authors of the world's best eBooks and eAudiobooks. BorrowBox is your library in one app.



A Justice of the Peace is available Monday, Wednesday and Friday 10 am - 12 pm



STORYTIME & SINGSONG

Join us for stories & interactive songs and a craft pack to take home.

Bookings essential
0 - 5 years. 9:15 - 10:00 Monday

To join this session please phone 55405473 or email the library - library.t@scenicrim.qld.com.au



LOTE Online for Kids - LOTE Online for Children allows children to enjoy the magic of books in World languages in the comfort of home. Each book is provided with an English translation to help develop multilingual reading and listening skills. Kids can also watch a selection of English only books with Australian, US and UK accents.

LIBRARY E-RESOURCES

Link from our website or download the app, and log in with your library card

Interesting Facts About Bookish Things

The Most Prolific Author

The author with the most published books is L. Ron Hubbard with 1,084 works. His first written piece was published in 1934 and his last was published in 2006.

The Youngest Author

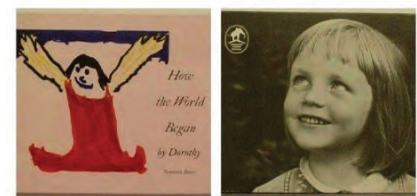

Dorothy Straight was only four years old when she wrote and illustrated *How the World Began* for her grandmother. It was officially published two years later.

The Oldest Author

The world's oldest published author, Bertha Wood, was 100 when her memoirs *Fresh Air and Fun: The Story of a Blackpool Holiday Camp* was released. She began the book at age 90.

The First Published Aboriginal Australian Author

David Unaipon was the first Aboriginal author to be published in 1924. He was commissioned by the University of Adelaide to assemble a book on Aboriginal legends. He also published three short booklets of Aboriginal stories in 1927, 1928 and 1929.

Our Book Choice: *The Book of Hidden Wonders* by Polly Crosby

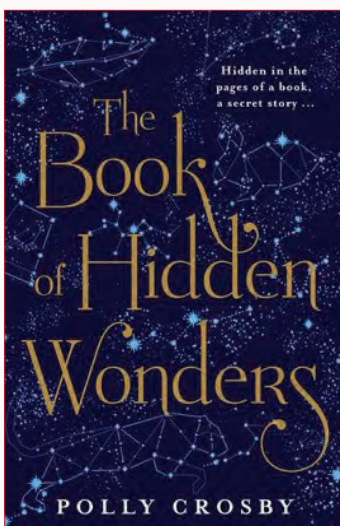

A charming, deeply imaginative debut novel about a young girl who is immortalised in her father's illustrated books containing clues to their family secrets.

Romilly Kemp and her eccentric father have happy but sheltered lives in a ramshackle mansion in the English countryside. To help make ends meet, he creates an illustrated book with Romilly—striking girl with red hair and a mole on her cheek—as the heroine, with her cat, Monty. The book becomes an instant success and their estate is overrun with tourists and adventure seekers after rumors spread that hidden within its pages is an elaborate treasure hunt.

As Romilly gets older and her father writes more books, he starts disappearing within himself. She returns to his illustrations, looking for a way to connect with her ailing father, and finds a series of clues he's left just for her. But this treasure hunt doesn't lead her to gold or precious stones, but something worth far more—a shocking secret that is crucial to understanding her family.

Written with tremendous heart and charisma, *The Book of Hidden Wonders* is an unforgettable story about growing up, facing mortality and discovering the hidden wonders that make us who we are.

Genre: Fiction, Magical Realism

LIBRARY OPENING TIMES MON-FRI 9AM-5.30PM • SAT 9AM-12PM

Tamborine Mountain Library is proudly operated by Scenic Rim Regional Council.

Bookshop & Art Gallery - Under the Greenwood Tree. Open 5 days 10 - 5. Closed Tuesday and Thursday Home deliveries 7 days. Book orders welcomed. 92 Main Western Rd Nth Tamb Ph.0424 586 066 P

Gardening, Mowing, Property Maintenance by friendly, reliable long-term mountain resident. No.1 Property Maintenance. Call Phil 0476 257 045 P

Music Lessons - Bass, guitar, piano. All ages. Have fun & online lessons available now. Ph Craig or text 0478 075 642 P

GRAPHICS & TUITION

GRAPHIC DESIGN/ILLUSTRATION SERVICE & TUTORING



GRAPHICS SERVICE: Business Startup – logos, business cards, letterheads, leaflets, stickers, etc. Quotes for design and printing (**all printing done locally by Coomera Print Hub**)

TUTORING & WORKSHOPS: Children's illustration/cartooning workshops. Tutoring graphic design working with Adobe Illustrator and Photoshop.

INFO: Call Heather on 0415 549 522 or email heather.dale@patchworkdog.com Examples on www.patchworkdog.com.



- Get your ad in front of more than 20,000 readers each week
- Free online exposure, and online advertising opportunities

Call or email

0417 238 238

advertising@scenicnews.com.au



SIGNS

GARAGE SALE SIGNS

Stand out from the crowd with attractive, professional-looking signs for YOUR Garage Sale. (spike/stand included) Signs are free to use, but require a \$10 deposit per sign (refunded when you return them). **Please inquire on 5545 5000.**

Please note: 2 days' notice required

POSITION VACANT

SKYWALK – Casual Staff Required
Café and Customer Service Position
Weekends and Public Holidays essential. Daytime hours only. Please deliver resumé in person to the Skywalk.

POSITION VACANT

Casual Shop Assistant for busy Bakery, please message Eagle Heights Bakery on [facebook](#)



Yoga Under the Bodhi Tree – LIVE YOGA CLASSES: Mon 9.30am Moriarty CC, Canungra. Mon 6pm Canungra Wellness, Canungra. **Tues 9.30am and Sat 9.00am** Zamia Theatre, Main Rd, Tamborine Mountain. **Wed 6pm** Creative Art Centre, Wongawallan Rd, Tamborine Mountain. **ONLINE YOGA CLASSES:** **Tues 6pm, Wed 9.30am.** For Online Classes text or email me: Margot **0428 137 391** or yogaunderthebodhitree@outlook.com. I will send you an email with a link. Very simple, very low tech. Come and join us! Hatha, Nada and Tantra Yoga. Contact: Margot Y.A. (Australia) **0428 137 391.** Transform your Life with Yoga.

TRIVIA

Adopted Words



1. From which language does the word 'ombudsman' come?
2. Which German word, meaning satisfaction or pleasure in the misfortunes of others, has come into English usage?
3. Which French words describe a general policy of non-interference?
4. The word 'schmaltz', meaning sentimental or mushy, comes from which language?
5. 'Angst', a description for a general state of anxiety, comes from which language?
6. What is the meaning of the Italian word 'opera'?
7. From which language does the word 'futon' come?
8. What is the literal translation of the French word 'cuisine'?
9. Which French phrase means 'reason of existence'?
10. The Russian word 'perestroika' is often heard, but what is the literal meaning?
11. Relating to the time of day, what do AM and PM mean?
12. 'Eureka', translated as 'I have found it', comes from which language?
13. What is the literal meaning of 'coup d'état' often used to describe the overthrow of a government?
14. 'Chutzpah' meaning 'effrontery' or 'cheek', comes from which language?
15. What does the German word 'Weltschmerz' mean?
16. Which Spanish word means 'a follower' or 'a fan' of something?

BUSINESS DIRECTORY – WHO TO CALL

ACCOUNTING

HALL HANNEFORD
 CHARTERED ACCOUNTANTS
TAXATION / BAS RETURNS
BUSINESS ADVICE • STRUCTURE SETUPS
SELF-MANAGED SUPERANNUATION
TAX PLANNING • BOOKKEEPING
 Shop 3/15 Main Western Road,
 Tamborine Mountain
 PH: 07 5545 2588
 www.accountingonthemountain.com.au

Eagle Taxation
 Accounting and Taxation Services; Tax Returns;
 BAS Statements; DIY Super and Auditing; ABN
 Applications; Tax Planning and Structure
 Advice; Non-Profit and Business Audits;
 End-of-Life Planning and Document Preparation;
 Commercial Agreements; Xero Cloud Accounting
36 Southport Ave, Eagle Heights
 ☎ (07) 5545 4458
 ✉ office@eagletax.com.au

Lakehouse Accounting
 Let's talk about your business and tax concerns!
 Call Noel 0487 999 035
 for an appointment or email
 noel@lakehouseaccounting.com.au
 20 Bateke Road
 Tamborine Mountain
 QLD 4272

AIR CONDITIONING & REFRIGERATION

+45 Years
TAMES
TAMBORINE MOUNTAIN
ELECTRICAL SERVICES
 Air Conditioning Service & Breakdown
 Sales and Installations
 at Competitive Pricing
Call Now 07 5545 7777
Servicing our customers for 45+ years
 Licence No. 69488 Arctick AU3560

EMIRG
 SERVICES
AIR CONDITIONING
COMMERCIAL REFRIGERATION
& MECHANICAL SERVICES
BRENDAN GRIMES 0419 009 643
 brendan@emirgservices.com.au emirgservices.com.au

Next ISSUE:
MARCH 17, 2022

ARBORIST

MOUNTAIN TREES
NICK ROUTLEDGE
 0438 176 775
 Qualified Arborist
 mountaintrees@live.com.au
Professional Tree Services

AUTOMOTIVE REPAIRS

TAMBORINE MOUNTAIN
Auto Clinic
Jason Bowles
 • Logbook Servicing All Makes Incl Euro
 • Specialist in Brakes
 • All Mechanical Repairs **RACQ**
 • Small Electrical Repairs
 • Sublet R.W.C & Air Conditioning
41 Main St Nth Tamborine Ph: 5545 1214

On The Road EST. 2002
AUTOMOTIVE REPAIRS
 • Mobile Repairs, Logbooks & Servicing
 • RWC Safety & LPG certificates
 • Cars, Trucks, Trailers & Floats, Farm Eq't
 • Light & Heavy Diesel Repairs
 • COI & Measure Ups, Mod. Plates
 • Scan Tool Diagnostics
FULLY EQUIPPED WORKSHOP AT TAMBORINE
SEAN 0409 291 053
 ACN 111 041 751

BLINDS & CURTAINS

TAMBORINE BLINDS
AND AWNINGS
 ✓ Awnings ✓ Blinds
 ✓ Security & Flyscreens
 ✓ 25 Years Industry Experience
RICHARD m: 0405 631 655
KENT h: 5545 0057

BOOKKEEPING

Innovative
 BEAN COUNTING
 BAS and Bookkeeping Services
Focus on your business while we count your beans!
 XERO & MYOB Certified Advisor, QuickBooks, Receipt Bank & Hubdoc partnered. 20 Years of experience!
 E: info@ibcounting.com.au
 W: www.ibcounting.com.au
 P: 07 5543 4830
 M: 0400 395 805
 AUSTRALIAN BOOKKEEPERS NETWORK AUSTRALIAN BOOKKEEPERS ASSOCIATION
 BAS agent 25894697

BOOKKEEPING

Cultivate your Happy
harvest
bookkeeping
 Bookkeeping, Payroll Admin & BAS Agent
 Call Kloe 0402 097 670
 hello@harvestbookkeeping.com.au
 www.harvestbookkeeping.com.au
 BAS agent 3008417

BOOKSHOPS

CANUNGRA
BOOKS & ART
Vintage to Now
 • Quality second-hand books
 • New books by local authors
 • Vintage clothing and records
 • Gifts and cards
We buy quality books and records
 Open daily 9.30am to 4pm
 6 Kidston St, Canungra Enquiries: 0418 792 161
 E: admin@canungrabooksandart.com.au
 Web: canungrabooksandart.com.au
 f canungrabooksandart

BRICKLAYING

HOPE
 BRICKLAYING
 Brick and Block Work • Cottage
 • Commercial Construction
 • Retaining Walls and Fences
 Tamborine Local
 QBCC Lic 1302284
0449 622 639
 Jhbricklaying@hotmail.com

BUILDERS

HAYWARD BUILT
 BUILT TO LAST
 Decks | Pergolas
 Bathrooms | Extensions
 External & Internal Doors
 Renovations | Pool Areas
0421 199 135
 ☎ ☎ ☎
 QBCC: 15203283

CRAMP BUILDERS
 Pty Ltd
 Architectural Homes Renovations Extensions Maintenance Commercial Works
 Nick Cramp - 0437 017 297
 Rick Cramp - 0407 701 875
 E: info@crampbuilders.com.au
 ACN 137 984 715 QBCC Lic. 1177904

BUSINESS DIRECTORY – WHO TO CALL

BUILDERS



All Aspects Of Building & Renovations

- RENOVATION SPECIALIST
- BATHROOMS
- KITCHENS
- FULL INTERNAL

Edward Odisho
mob: 0418 788 029

QBCC LIC - ISO77381
email: totalbuildingi@gmail.com

BUILDING DESIGN

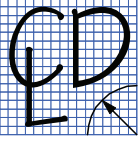

CAMERON DESIGN LOGIC

Adam Cameron
0414 807 265
camdunpl@gmail.com

QBCC 15189980

BUILDING DESIGN & PLAN DRAFTING 

CAR DETAILING

CAR DETAILING – MOBILE SERVICE

Ian Garvie
JP (Qual)

Qld Water Comm. & Commerce Qld
REGIST. WATER EFFICIENT OPERATOR No. 2238

0409 962 348
Health Regulations strictly adhered to



CAR REMOVAL

FREE CAR REMOVAL
Paying for some cars and 4x4.
Can ring for an obligation-free quote on your car

0438 761 669

CHIMNEY CLEANING

SOOTY'S CHIMNEY CLEANING SERVICE
Dust-free cleaning - all areas

sootyschimney@optusnet.com.au
www.sootyschimneycleaning.com.au

0438 733 579



CLEANING

Eagle Heights Cleaning Services
Commercial Cleaning

House Cleaning Weekly/Fortnightly

Bond Cleans

MOBILE 0400452054

Cleaning The Mountain since 2001

Next deadline:
MARCH 11, 2022

Colour listings
from \$12/week

COMPUTERS



MasterCard
VISA
e
efpos

GRANT I.T. SERVICES

0410 559 136
CAMRON GRANT
grant.it.services@gmail.com

Professional & reliable
ON-SITE TECH SERVICE
for your home or business

PC, Apple or Smart Devices - Repairs - Installations - Upgrades - Networking - Virus Removal & More

LOCAL & SAME DAY RESPONSE



Onsite in your Home or Business - Installations - Repairs
Upgrades - Virus Removal - Networking - Backups & more
Supporting PCs / Macs / Tablets / Smartphones

call Drew Haldane **0414 014 054**

For all your computer needs

COUNSELLING

Tamborine Mountain Counselling

5545 1245

Principal Counsellor: David Mackay

- Personal Issues
- Anxiety
- Self-Esteem
- Grief
- Adolescents/Youth
- Family

Private Health Fund Approved

MEMBER OF  **ACA** AUSTRALIAN COUNSELLING ASSOCIATION

Blue Card
ABN 79 130 029 431
ACA member 20380

DENTAL PRACTICE

DENTURE CLINIC



Joe Russell
Registered Dental Prosthetist

OPEN

for all your denture requirements

www.tamborinedentures.com

5545 3128

Mon-Fri Every week (excl. holidays)
After-hours appointments available

Shop 10/17 Southport Ave
Tamborine Mountain

DRESSMAKING

JULIA SINGH
FASHION AND TEXTILE DESIGNER

- DRESSMAKING
- PATTERNMAKING
- WORKSHOPS
- ALTERATIONS

TAMBORINE MOUNTAIN
0467 398 872
HSINGH@WESTNET.COM.AU



DRIVING LESSONS

TAMBORINE DRIVING SCHOOL
Auto and Manual

L **0431 857 356**

Nicola Durkan
Qualified Driving Instructor



Free Keys2drive lesson
www.tamborinedrivingschool.com

RED LINE 

TAMBORINE MTN DRIVING SCHOOL

Accredited Driving Instructor
Long time local resident

Phone Grant 0478 225 853
Member Aust Driver Training Association

Suzuki Swift Auto

EARTH MOVING

FREE QUOTE CALL
0413 941 172

30 YEARS' EXPERIENCE
IN ALL ASPECTS OF EARTHMOVING



DANNY'S DIGGERS

Bobcat & Excavator Hire

GRAYS EARTHWORX

5 tonne Excavator, 10 m² Tipper

All Excavations, Postholes,
Rock Walls, Sand, Soil, Gravel

Reliable - Good Rates

PH: GRAY 0431 243 810

Scenic News

- Get your ad in front of more than 20,000 readers each week
- Free online exposure, and online advertising opportunities

Call or email
0417 238 238
advertising@scenicnews.com.au

BUSINESS DIRECTORY – WHO TO CALL

ELECTRICAL

Bob's Services

Gary Hamblin
Licenced Electrician
25 Years Experience

0413 278 743
thezoo5@bigpond.com



Lic. No. 71041



TAMBORINE MOUNTAIN ELECTRICAL SERVICES

Competitive Pricing and
Guaranteed Work from your
local Master Electricians

Call Now 07 5545 7777

Servicing our customers for 45+ years

Licence No. 69488

Arctick AU3560



ALL YOUR ELECTRICAL NEEDS FOR
RESIDENTIAL & COMMERCIAL

~ COMPETITIVE PRICING ~

Electricians that provide fast, tidy,
professional service

- New builds
- Renovations
- Upgrades
- Air conditioning
Installations



Call us on **1300 153 726**
admin@knightsselectrical.net.au

Knights Electrical Contracting (QLD) P/L * Licence No: 65556 (QLD)

FIVE STAR SECURITY & ELECTRICAL

Lic. No. 59907

ELECTRICAL CONTRACTORS

Domestic • Commercial • Repairs
• Renovations • Upgrades

Phone: **0418 715 380**

SKS Electrical Pty Ltd

Lic No. 73960

Stuart Spalding

0413 435 708

skselectrical11@hotmail.com



Michael Ruttle
0422 882 719
Ruttle@interlectrics.com
Lic:100994

Electrical Installations
New & Renovation
Phone and Data
Fair Prices &
Professional Service
Local to the Mountain

ENGINEERS



General Engineering

Milling and turning service
Mig welding & light fabrication
Reverse engineered parts
45t shop press
Trailer and horsefloat repairs
Over 30 years experience

No job too small
Free quotes & friendly advice
Free pickup & delivery tamborine village
and surrounds

B.J. Barnard
0457845458

beezkneezengineering@yahoo.com



FIREWOOD

TD McNEILL

QUALITY FIREWOOD

Split, Dry 100% Ironbark by the Tonne
18 Years in Business Locally

When Only the Best Quality will Do!

Phone Trent **0457 244 525**

Aged Western Red Ironbark

From \$180 m³

Phone Wayne Kiehne **0419 768 959**

FITNESS & GYM

JOIN YOUR LOCAL GYM

ACCESS AVAILABLE 24/7

Personal Training & Classes
Follow Facebook@MainFitness
OR www.mainfitness.com.au

8/39 Main St North Tamborine
5545 4774 24/7

MAINFITNESS



TRIATHLON CLUB
16 BEACON ROAD,
TAMBORINE MOUNTAIN

24/7 Community Gym
for all levels of fitness

Contact Natasha
if you are interested
in joining.

Mobile: **0408 739 844**

GARAGE DOORS & GATES

Adept Garage Doors & Gates



SPECIALISING IN:
Servicing, Repairs, Maintenance,
Installation, Automation & Remotes.
Quality Service, Workmanship & Products

24/7 Emergency Repairs
Ph: **0401 363 757**
www.adeptgaragedoors.com.au



HAIRDRESSING

LMR BARBER SHOP

Fades, haircuts, beard trims, all kids' cuts,
cut throat shaves and head shaves

SHOP 10, 9-13 Main Western Rd Tamborine Mtn 4272



f lmrbarbershop

GAS SUPPLIES

Joyan Household Gas

YOUR FRIENDLY LOCAL SUPPLIER

We supply and deliver household gas cylinders
No Rental Charges No Lock In Contracts
No Delivery Fee

Call John **0424 486 986**



HOUSEHOLD GAS SUPPLIES

Fast.....

Reliable.....

Local.....

PLUSGAS
.com.au

5548 7100

Locally owned and operated

GUARANTEED SAVINGS
when changing from another supplier



HAIR & BEAUTY

Create The Image

HAIR & BEAUTY

0427 980 450

34 Christie Street, Canungra



Hair by Melissa

• LADIES • MENS • CHILDREN
• Cutting • Colouring • Styling

Complete In Home Hair Service

Stuck Indoors - I Come to You

0416 825 465

HANDYMAN

Craig the Handyman

For any odd jobs you have wanted done

• Affordable • Reliable • Quality work
• 30 Years Experience

Not your average handyman!

0478 075 642



HARDWARE

TAMBORINE VILLAGE TRADERS

HARDWARE – PLUMBING – PRODUCE
SADDLERY – GARDENING – PAINT

M-F 7.30 to 5.30 Sat 7.30 to 3pm Sun 7.30 to 1pm

Ph: **07 5543 8822**
Fax: **07 5543 8866**

Email: christina@tamborinetraders.com.au

Christina
5 Leach Road
Tamborine QLD 4270

HOME & GIFTWARE

lux & gather

Luxury home & giftware boutique

07 5545 0804

Monday - Friday 9 - 3

Saturday 9 - 3

Sunday 9 - 2

Shop 3, 14 Main Western Road,
Tamborine Mountain

BUSINESS DIRECTORY – WHO TO CALL

LANDSCAPING & MOWING

Hartley Road
Landscaping Supplies
& Equipment Hire



07 5545 3390

STONES | GRASS | ROCKS | SOIL | MULCH
www.hartleyroadlandscaping.com.au

Affinity Landscapes

*Is your garden ready for spring & summer entertaining?
Would you like to attract wildlife?
Do you want envious friends & neighbours?*

Local horticulturalist & lic'd structural landscaper

- Design • Water features • Stonework • Planting
- Paving & retaining walls
- Contemporary, native & formal gardens

MOB: 0411 805 589 – QBCC1115404

Dependable Mowing & Kanga Mini Loader Hire

We've Got Your Property Covered!

Small & Large Acreage Mowing
Zero Turn Catching/Mulching Mower
4WD & 6WD Steep Slope Mowers/Slashers
Professional Lawns Maintenance,
Topsoil Dressing, Aerating, Dehatching,
Over Seeding, Fertilising, Spraying,
Back Yard Earthworks, Trenches, Soil &
Mulch Shifting, Post Holes, Landscaping

**Phone/Text Ash Fully insured
0430 110 055**

TAMBORINE TURF
(Est. 1966)

Landscaper & Laying Service Available

Growers & Suppliers of:

- Wintergreen Couch • Buffalo Grass • Kikuyu Turf

Farm Pick Up or Delivered – Inspections Invited!
(Weekend pickup must be ordered by noon Friday)

tamborineturf.com.au • tjyore@optusnet.com.au

Tom 07 5543 6133 • Office 0423 924 692

LOCKSMITH

Paul's Locksmith Service

- ✓ Over 35 Years of Experience
- ✓ Master Locksmith Since 1989
- ✓ Prompt & Reliable Professional Service at Sensible Prices
- ✓ Scenic Rim Resident

Residential • Commercial
7am - 7pm • 7 Days A Week

Call Paul 0439 355 411

paulslocksmithservice.com.au

MOWING & GARDENING

GREENWOOD PROPERTY MAINTENANCE

- All lawns – small blocks to acreage
- Hedge trimming
- Brushcutting
- Rubbish removal
- Gutter cleaning etc

PHONE JOHN 0431 953 126



PAINTING

ALL SURFACE PAINTING P/L

- Re-paint Specialists
- Specialise in Timber Restoration
- New Projects Welcome

JOHN RYAN
M: 0414 377 474
E: allsurfacepainting1@gmail.com

VINCENT'S PAINTING SERVICES

- Interior/Exterior Painting
- Roofs & Decks

QBCC 1090914

5545 0098 or 0409 879 184

CJR Queensland
Painting and Maintenance Services

Colin Rose
0414 818 318
cjrose@bigpond.net.au

Painting Contractors

RESIDENTIAL & COMMERCIAL

Gary 0438 175 069
Email: garywferigo@hotmail.com

FREE QUOTES • PROMPT SERVICE



QBCC 1001805

PAINTING

Lowrie Painters

QBCC: 1024341
Interior – Exterior
Quality finish – Mountain Local

Call Matt for a competitive quote

0422 948 753

lowriepainters@gmail.com painter-goldcoast.com.au



PANEL BEATER

ALLAN HAYES TAMBORINE MOUNTAIN PANEL & PAINT

PH: 5545 2319
Mob: 0419 735 874

*Private and insurance work
Total Car Care*

FREE QUOTES PICK UP DELIVERY



WINDSCREENS BRAKES RUST FOR R.W.C.

1 HAYES RD
OFF TAMBORINE OXFORD RD

PEST CONTROL

EAST COAST building & pest

Your local, trusted, family owned and operated team

- Building and Pest Inspections
- Termite Inspections
- Termite Management
- Pest Control

1300 910 917

admin@eastcoastbuildingandpest.com.au
www.eastcoastbuildingandpest.com.au



Colour listings from \$12/week

Next EDITION: MARCH 17, 2022

Answers to TRIVIA – from page 23

- 1 Swedish, 2 Schadenfreude, 3 Laissez-faire, 4 Yiddish,
- 5 German, 6 A work, 7 Japanese, 8 Kitchen, 9 Raison d'etre,
- 10 Reconstruction, 11 Ante Meridiem (before noon) Post Meridiem (after noon), 12 Greek, 13 Blow of state,
- 14 Yiddish, 15 World pain, 16 Aficionado.

BUSINESS DIRECTORY – WHO TO CALL

PEST CONTROL

Safe Effective Treatment of ALL PESTS

Termite inspections using the latest technologies: Thermal Image Camera, Termatrac etc., and all aspects of Termite prevention and eradication.



END-A-PEST

Exterminators

Over 30 Years' Exp.

Fully Licenced & Insured QBCC 15023710

5545 3957 or 0407 590 790

PHYSIOTHERAPY



Tamborine Mountain

Gary Brooks

tel: 07 5545 0500

16-18 Main Western Rd, Tamborine Mountain

PHYSIQUE

PHYSIOTHERAPY



2/10 Main Street, PO Box 102
North Tamborine, QLD 4272

5545 1133

www.physiquehealth.com.au

PICTURE FRAMING & PRINTING

vikingframer.com



Viking Framers
INDUSTRIES

Picture Framing • Art Gallery • Printing
vikingframer.com

(07) 5545 2402 0449 250 545

PLUMBING

ALL-WAYS PLUMBING Lic No 745184

Specialising in:-

- Maintenance
- Plumbing
- Roofing
- Draining
- Gasfitting

Ph: Dave Angel at Nth Tamborine
Ph: 5545 2369 all hours
Mobile No: 0419 677 008

COBRA PLUMBING

& Drain Clearing P/L QBCC 73572

Maintenance Services
Renovations • No Job Too Small

Mark: 0419 655 802 Local Resident

Want to get YOUR
business noticed?

0417 238 238

advertising@scenicnews.com.au

PLUMBING

Hot Water Install & Repairs Solar, Electric & Gas.

Trust the family owned local
Best service & price!

Ph: 5539 6820



**TODD'S
PLUMBING
& ELECTRICAL**

www.toddsplumbing.com.au

PUMPS



For sales, service
& advice
you can trust ...

Mountain
Pumps

House | Filtration | Irrigation | Bore

PHONE 5545 0555 and 5545 4100

We supply & repair PUMPS

- Bore pumps • House Pumps
 - Pool Pumps • Grey-water Pumps
- IRRIGATION & WATER SPECIALISTS

Sales & service
38 Main St, Nth Tamborine
(2 doors from POST OFFICE)

AJ's Pump Repairs and Services

ABN 63 677 153 402



Joe: 0434 965 349

joesvet@bigpond.net.au

111 Boomerang Road
Tamborine QLD 4270

REAL ESTATE



Charmaine Wigglesworth

0460 444 100

charmaine.wigglesworth@professionals.com.au

5543 6444 2205 Beaudesert-Beenleigh Rd, Tamborine
www.ProfessionalsTamborine.com.au

REAL ESTATE



Team – Heleen & Ton

0424 591 011 0424 591 012

heleen@Professionals.com.au Ton.Wolf@Professionals.com.au

5545 5000, 10-12 Main St, Tamborine Mountain
www.ProfessionalsTamborineMountain.com.au



Linda Hogan

0414 300 558

linda.hogan@professionals.com.au

5545 5000 10-12 Main Street, Tamborine Mountain
5543 6444 2205 Beaudesert-Beenleigh Rd, Tamborine



SARAH AMY SHANELLE



0429 001 013 0474 315 000 0447 660 080
Sarah Lewis Amy Orr Shanelle Hadfield

10 - 12 Main Street, Tamborine Mountain, 4272
www.ProfessionalsTamborineMountain.com.au
2205 Beaudesert-Beenleigh Road, Tamborine, 4270
www.ProfessionalsTamborine.com.au

07 5545 4000 Mountain Office 07 5543 6444 Tamborine Office

Property Management

The best team to manage your investment



Team Erin & Monique

0427 078 757 0429 004 840

erin.mcgee@professionals.com.au
monique.clemens@professionals.com.au
5543 6444 2205 Beaudesert-Beenleigh Rd, Tamborine
www.ProfessionalsTamborine.com.au

BUSINESS DIRECTORY – WHO TO CALL

REAL ESTATE

 Professionals Serendipity Real Estate



Team Michael & Diane
0434 718 162 0424 653 316
michael.kratzke@professionals.com.au
diane.pihl@professionals.com.au

5545 5000 10-12 Main Street, Tamborine Mountain
www.ProfessionalsSerendipityRealEstate.com.au

 Professionals Serendipity Real Estate



Elizabeth Stirling
0400 449 978

elizabeth.stirling@professionals.com.au
5545 5000 10-12 Main Street, Tamborine Mountain
www.ProfessionalsTamborineMountain.com.au

Cherie Todd
0411 466 442



RayWhite

Shop 6,
9-13 Main Western Rd
North Tamborine
07 5545 1303

cherie.todd@raywhite.com
www.raywhiteruraltamborinemountain.com.au

 EXCLUSIVE SALE PROPERTIES



Thinking of
selling?
call me

Now

KONRAD GALLAHER
0435 99 66 44

LOCAL Independent Agent

TESTIMONIAL

WE ARE EXTREMELY GRATEFUL FOR HIS EXCELLENT WORK AND STRONGLY RECOMMEND KONRAD, LEWIS AND LIZ.

30 + YEARS LOCAL RESIDENT
30 + YEARS SALES EXPERIENCE

konrad@exclusivesale.com.au
exclusivesale.com.au

REAL ESTATE

B

BARTLE REAL ESTATE



Louis Bartle 0491 642 980
Jodi Meynell 0412 554 274

louis@bartlerealestate.com.au
jodi@bartlerealestate.com.au

bartlerealestate.com.au

 Venter Property



Warren Venter

0432 606 719

warren@venterproperty.com.au

Making real estate easy

Harcourts Scenic

Scenic Rim Real Estate

scenic.harcourts.com.au
tamborine@harcourts.com.au

07 5543 8525

It is about people,
it is all about you.



Jess Hamilton
Sales Consultant
0434 163 335

COAST TO COUNTRY

REAL ESTATE

'Independence, honesty and integrity in real estate'

The Scenic Rim's
Place for Property!

(07) 5676 7722
www.ctcre.com.au

ROOFING

Martin Foster

QBCC 57756

Leak Specialists
FOSTERS ROOFING & GUTTERING

Your local Tamborine roofer. Over 35 Years' Exp.
Roofing, Guttering, Leaf Guard, Whirlybirds
Leaks and Maintenance

Ph 0417 748 073 Office 5543 8310
fostersroofingptylt@bigpond.com

AGENCY UNO PTY LTD - Builder
LIC # QBCC 1203987

Repairs and replacement of roof, gutter,
downpipes and timber work.
Advise and quote.

Call: **Simon**
Mb: **0422 532 397**

SEPTIC TANK CLEANING

Septic Solutions QLD
Locally Owned & Operated

Pumping & Cleaning of
Septic, Sullage and Holding Tanks
Grease Traps & Sewerage Treatment Plants

PH: Tony 0439 430 242

After hrs: 07 5543 0242

POWER PUMPING
DOMESTIC SERVICES

Treatment Plants Septic Tanks
Sullage Tank Grease Traps
Servicing & Repairs

T 55452692 M 0408633260

www.yoursepticssystem.com.au

SIGNWRITING & AUTO ART

 Auto Art Signs
SHOPFRONTS
CAR, TRUCK, BOAT WRAPPING
VEHICLE SIGNS
LIGHTBOXES
BANNERS
A-FRAMES
DIGITAL PRINTING
BUSINESS CARDS
FLYERS etc
DESIGN

Call Chris

0410 058 204

autoartsigns@bigpond.com

GOLD COAST - MT TAMBORINE - CANUNGRA - BEAUDESERT

SKIP HIRE

GREENSKIPS



formerly Tamborine Skips
(still under same ownership/team)

2-12m³ (cubed) bins
available, domestic or commercial

Book online or phone: **0421 507 303**

greenskipsgld@outlook.com | www.greenskipshire.com.au

Locally owned and operated

Business Directory
Colour listings
from \$12/week

BUSINESS DIRECTORY – WHO TO CALL

STORAGE

ALL TAMBORINE STORAGE

108 MAIN WESTERN ROAD
TAMBORINE MOUNTAIN
PHONE 0417 001 536

SWIMMING POOL SERVICE



For sales, service & advice you can trust ...

PHONE 5545 1126

- Sales, Service and Installation of Pumps, Filtration, Heaters & Cleaners.
 - One off and regular Pool & Spa servicing
 - Pool Chemicals
 - Small Motors and Machinery Servicing
- Monday – Friday 8:30am to 4:30pm Saturday – 8am to 1pm
Closed Sunday & Public Holidays
Shop 2/24 Main St, Nth Tamborine

TELEVISION

JUSTRITE VIDEO SERVICE

SPECIALIST ANTENNA INSTALLATIONS
SATELLITE TV AND DIGITAL RADIO
HOME THEATRE • EQUIPMENT SETUP
WI-FI • TV, PHONE & DATA POINTS

32 Years Experience **Bruce Howsan** Lic No 71342
Ph: **5543 8374** Mb: **0438 761 595**

TILING

Tiling

QBCC LIC. 69815

Adam Sander
0417 616 307

Wall & Floor Tiler

Servicing the Scenic Rim for 10 years

- New & Renovation Work
- Wet Areas & Waterproofing

Peter Himberg 0412 263 556

QBCC: 56316
ABN 46 749 809 882

TREE SERVICES

Batchelor & Sons

LAND CLEARING
STUMP REMOVAL & EXCAVATION

- 24/7 Tree Arborists
- 28+ Years of Experience
- We Care for Your Trees

Call Us **0419 686 908**

Let's talk about your tree care needs!

TREE SERVICES

Tamborine Mtn

Affordable



Tree Service
0418 980 862

Removal & Trimming
Chipping & Stump Grinding
ADAM ROUTLEDGE

TYRES

TAMBORINE MOUNTAIN TYRES
4/39 MAIN ST 5545 2111

- AGRICULTURAL
 - TRACTOR
 - TRUCK
 - NEW WHEELS
 - TYRE REPAIRS
 - FREE TYRE SAFETY CHECK
 - FREE AIR IN YOUR TYRES
 - WHEELBARROW
 - RIDE-ON
 - ATV & QUAD
 - WHEEL ALIGNMENT
 - TUBES
- Find us on **Facebook**
tamborinemountaintyres.com.au

VET SURGERY



Tamborine Mtn

24 Main Street
North Tamborine

5545 2422

all hours

VETERINARY SURGERY

Mon-Fri 8am-6pm. Saturday 8am-1pm

After Hours Emergency Service Available



Canungra

Cnr Pine Road
& Franklin Street

5543 5622

all hours

VETERINARY SURGERY

Mon-Fri 8.30am-5.30pm. Sat 8.30-11.30am

After Hours Emergency Service Available



Yarrabilba

Cnr Wongawallan Dr
& Adler Circuit

3180 3096

all hours

VETERINARY HOSPITAL

Mon-Sat 8am-6pm. Sunday 9am-12noon

After Hours Emergency Service Available

BALANCE VET



BALANCE VET
REHAB

- Housecalls
- Conventional Medicine
- Physical Rehab
- Acupuncture
- Chiropractic

0431 263 728

WATER SUPPLIES

PONY EXPRESS



MOUNTAIN WATER

Est 1985 - Maurice & Debbie
Friendly, Reliable Delivery

\$190 per load

BSC Approved

7 DAYS A WEEK

Ph: 5545 3935 or 0417 644 498



Quality Mountain Water

100% UV Filtered

Lic. approved by SRRC

Also Gravels, Sands, Soils

Roadbase Tipper Hire

Michael & Odette Johanson

Ph **5545 2225**
0407 718 203

WATER TANK CLEANING & REPAIRS



THE **H₂O TANK DOCTOR**

Lauchlan McConnell

QBSA 062446 (Est. 1988)

www.theh2otankdoctor.com.au

- Water Tank Cleaning & Repairs
- Minimum water loss cleaning systems
- Water filtration solution "Roof to Tap"

Servicing all areas • Free quotes & advice most areas

Ph **5545 3693** or **0407 649 659**

WEDDING VIDEO SERVICES

Brisbane-based Videography,
specialising in wedding films that
capture the natural love
& laughter of your
day! Also servicing
Sunshine Coast &
Gold Coast regions.
T&C's may apply



www.facebook.com/aleishagracefilmandphoto/

vimeo.com/aleishagracefilmandphoto

WELDING & FABRICATION



MOBILE WELDING and FABRICATING

EXPERIENCED IN (BUT NOT LIMITED TO):

- Mobile plant & machinery maintenance & repairs
- Farm fence strainer posts & corners custom-built on-site
- Cattle rail fence lines or stable dividers
- Structural steel fabrication & erecting, Shed erection

FULLY INSURED, FULLY MOBILE ONSITE WELDING SERVICE
PLEASE CALL OR TEXT LEX ON 0423 668 542

0423 668 542

WELLNESS AND HEALTH



Sally Glenister
REFLEXOLOGIST

21 years' experience

One of the World's most ancient
and powerful natural
methods of healing

EAGLE HEIGHTS



0438 735 908

www.sallyglenister.com

REGULAR MOUNTAIN ACTIVITIES

BADMINTON Social players, all levels. Mon 6.00pm to 7.30pm at the Vonda Youngman Community Centre (except Public Holidays).

BOOK READERS GROUP meets once a month, new members welcome. Enquiries at TM library.

BOTANIC GARDENS Forsythia Dr, Eagle Hts - Volunteers' working bee every Thurs morning 8-12. 0409 263 666

FILM CLUB AT THE ZAMIA. Meets every third Sunday at 5.30pm for 6pm screening. Only \$10 annual fee to join which gives automatic membership to the Tamborine Mt Little Theatre group. All movies are free with membership. Films shown range from the classics to foreign and Australian made. Cabaret seating and the old sling back chairs make it a great evening of entertainment where you can bring along your own refreshments or a take away to enjoy during the film.

FRIENDS OF TAMBORINE NATIONAL PARK : meet on the first Saturday of the month (except Jan.) To find out where we will be working contact Len on 3355 7288 or 0428 335 572.

FRIENDS OF TM LIBRARY Quarterly booksales held, other volunteering opportunities available. Contact the library for further information 5540 5473.

MARTIAL ARTS: Kyokushin Karate and Brazilian Jiu-Jitsu. Bully Busters, Self Defence, Discipline. Tamborine Mountain Showgrounds Tues & Friday 5.00pm and Saturday 9.30am Contact Cameron: 0433 633 775

MEDITATION: Tuesdays 7pm – New Thought, New Life Centre 5545 3700.

MEDITATION: Tuesdays 9.30am. St Georges Anglican Church, cnr Dapsang Dr & Eagle Heights Rd. VAll faiths welcome. Contact Barbara 0497 016 178.

MOVIES ON THE MOUNTAIN: Regular screenings of latest releases at the Zamia Theatre. Ph 5545 3517.

RELAXED MIND TAI CHI: Mindfulness in motion, Mondays & Fridays 9.30am, Botanic Gardens. Bookings essential. Phone 0420 349 744.

ROTARY ON TAMBORINE MOUNTAIN meets every Wednesday night at 6.30pm for 7.00pm start at the Eagle Heights Hotel. New members and visitors welcome. For information, call David on 0419 743 275

SINGING 4-part Acappella singing for women of all ages. If you love singing, come and join us. 1st and 3rd Thursdays of the month. Knoll Road, North Tamborine. Ph Dianne 0413 339 821 or email bellaacappellatamborine@gmail.com

TAI CHI Tues mornings, Thurs evenings 110 Eagle Hts Rd, Eagle Hts. Phone Gai Wanless 5545 2409.

TAMBORINE MOUNTAIN COMMUNITY CARE ASSOCIATION: Service Provider for first - level aged care. Transport to medical appointments, Domestic Assistance, Home Maintenance, Social Support Individual & Group, Podiatry and Computer classes. Open: Mon – Fri 8:30 am – 4:30 pm. Volunteers welcome. Contact – 5545 4968 Address: 42, Southport Avenue, Tamborine Mountain, Qld.

TAMBORINE SUSTAINABLE GARDENERS SOC (TSGS), a group of enthusiastic gardeners, meets on the last Saturday of each month. Mrs Sue Morris 5545 0102.

TANGO CLASSES: Tango and salsa classes: every Monday night at the Zamia theatre. Salsa for beginners from 6.30-7.30pm and tango for experienced from 7.30-8.30pm. Cost is \$30 per couple or \$20 pp. Contact Alejandro at 0413 595 275.

TM ARTS COLLECTIVE: Meetings are usually held at 7.00 pm on the first Wednesday of the month at a designated location (call 5545 0043 for details). We always welcome visitors and enquiries from new artists and artisans. We stand for a stronger arts community on the Mountain, and continue to lobby for a local community gallery and arts hub. The Collective benefits from our association with the Brisbane Visual Arts Community (BVAC) and members participate in Brisbane and local arts events.

TM BOWLS CLUB – Friday social 1pm winter & 2pm summer; Sunday Scroungers 10.00am-12.00 noon; barefoot bowls & otherwise by arrangement. Competitions for members as notified. Free coaching, new members always welcome. Enquiries: 5545 1308.

TM BRIDGE CLUB meets each Monday at 5.45pm, Wednesday at 1.15pm, Thursday at 12.45pm and in an Assisted Play session on Friday at 12.45pm for those wishing to learn more in a social environment at the Tamborine Mountain Sports Complex, 400 Long Road.

TM CHAMBER OF COMMERCE: 2nd Wed. of month. Phone 5545 0944 Email: info@tamborinemountainchamber.com.au

TM COMMUNITY KINDERGARTEN ASSOC meets 2nd Wednesday of the month at the kindergarten 23 Coleman Square, North Tamborine at 7.15pm.

TM CREATIVE ARTS: Schedule of Activities MONDAY 9.00am-12.00 noon Patchwork, Quilting, Mahjong. 1.00pm-4.00pm Painting (Tutor fee) 1.15pm-4.15pm Creative Writing (1st,3rd,5th Monday of Month) 6.00pm-9.00pm Mens' Group 7.00pm-9.00pm Sculpture & Pottery **TUESDAY** 9.00am-12.00 noon General Craft, Sculpture & Pottery 9.30am-12.30pm Life Drawing (Model fee) **WEDNESDAY** 9.00am-12.00 noon General Craft, Bridge – 12.30pm - 4.30pm, Sculpture & Pottery, Spinning & Weaving, Embroidery (1st Wed of Month), Machine Sewing (last Wed of Month). **THURSDAY** 9.00am-12.00 noon Sculpture & Pottery, Botanical Drawing 9.00am-1.00pm Weaving (1st & 5th Thursday of month) 1.00pm-4.00pm Wearable Art, (Felting Dyeing etc) **FRIDAY** 9.00am-12.00 noon Wood Artisans, Sculpture & Pottery, 1.00pm-4.00pm Mahjong **SATURDAY** 1.00pm-4.00pm Yarners

TM CROQUET CLUB: Monday and Thursday mornings 8.30 on our green at Club Tamborine. Free coaching, new members always welcome to join us. Ph: Heidi 0488 440 296

TM FAMILY HISTORY GROUP Meetings held 1st Sunday each month (excl. January) at TM Historical Soc, Wongawallan Rd, Eagle Heights, 3–5 pm approx. Please contact Sharon on 0401 830 358

TM GARDEN CLUB: Vonda Youngman Community Centre, Main Street, North Tamborine. Feb - Nov, 2nd Tuesday 9.30. BYO morning tea. Enjoy: Guest speaker, plant sales, borrowing library books, raffle, plant problem solving and meeting fellow gardeners. New members and visitors most welcome. email: tamborinemtngc@gmail.com mobile: 0417 623 023

TM GOLF CLUB is open 7 days a week for golf. Ladies play on Tuesdays, Veterans play on Wednesdays and the main competition is on Saturday. Happy hour social event on Friday evenings from 5 pm. Coaching is available by Andrew Revie the club professional. Contact 5545 1788. Happy golfing!

TM HISTORICAL SOCIETY – Member working bee & morning tea every Tuesday mornings. New members always welcome. Please contact Phil Paley 5545 4962 or Muriel Shephard 5545 0481 for further details.

TM LANDCARE: Volunteering opportunities: Forest Regeneration Work: Judith Roland - 0429 808 206 for details; Helping at the Piccabeen Bookshop - 0403 783 757 during office hours

TMLETS: Join at Community Exchange System www.ces.org.za . Enq. 5545 3776.

TM LIONS CLUB Admin meeting held on the 2nd Tuesday and dinner meeting on the 4th Tuesday of the month. For more information please phone 5545 2120 or visit website tamborinemountain.qld.lions.org.au/

TM LITTLE THEATRE: Meetings held 1st Tuesday of month at 7.30pm at the Zamia Theatre. Regular plays, play readings & social events, movie club events. New members welcome. Cath Buckley President www.tmlt.com.au.

TM LOCAL PRODUCERS ASSOC. (The Green Shed) sells local produce, plants & flowers every Sunday, 6.30–11am at 378 Main Western Rd (next to TM Showgrounds)

TM MASONIC LODGE: Meets first Thursday each month, except December. Masonic Centre, 10 Knoll Road, North

Tamborine. Contact 3273 3313.

TM MEN'S SHED: Our workshop at 88 Beacon Rd (behind the tennis courts) is open each Tuesday, Thursday, and Saturday from 8:30 am to 12:30 pm. New members welcome. To find out more, drop in for morning tea and a chat or call our President on 5606 8367 or check out our web page at www.tmmensshed.com

TM NATURAL HISTORY ASSOCIATION: Birdwatchers – For further information call 5545 0995.

TM BUSHWALKERS, find out about us on the TM Natural History Association website. New members welcome. Enquiries: 0439 869 125 or 0478 414 892. www.naturalhistory.org.au.

TM NETBALL CLUB. Contact Tracey 0438 575 662.

TM ORCHESTRA rehearses from 7pm to 9 pm every Wednesday during school term time. The venue is Tamborine Mountain State High School at Holt Rd. New players always welcome. For more information, phone Danielle on 0423 210 949. Check us out on our website www.tmo.org.au; or find us on Facebook.

TM PRESBYTERIAN CHURCH 34 Main St, North Tamborine www.tmpcq.org.au Sunday Morning Service 9am (including kids church) and Evening Service 5pm (including kids church). Playgroup: Tuesdays 9.30am for 0-5 years. Youth Group: Fridays 4-6 pm for Years 7 – 12. Enquiries: dave.mugridge@tmpcq.org.au | www.tmpcq.org.au BARGAIN CENTRE: Tuesday to Saturday opens 8am – 12 noon (rear of the Presbyterian Church).

TAMBORINE MOUNTAIN COMBINED PROBUS CLUB: Enjoy the company of retired and semi retired women and men at our social club meetings for fun, friendship & fellowship at Club Tamborine Sports Club, 6-12 Beacon Road, North Tamborine on the second Wednesday of the month at 9.15 for 9.30 start. Lyndal Drennan, President 0450 907 670

TAMBORINE MOUNTAIN PROBUS CLUB INC (MEN'S CLUB): Join like-minded retired and semi-retired men for fun activities at Vonda Youngman Community Centre, 2-4 Knoll Road, North Tamborine on 3rd Wednesday of the month at 10am. Contact Bob Hepple on 0411 776 888 for details of next meeting.

TM PROGRESS ASSOCIATION: 1st Tuesday in month. 7.30pm Heritage Centre Wongawallan Rd

TM RSL Sub Branch meets at the RSL rooms underneath the Bowls Club; details are available by phoning President Phil Hunter 0419 662 961.

TM RUGBY: Training Monday and Thursday 3.45pm- 5pm at TMSA, Long Road. Please call John Knight 0400 554 555 or Adam Clarke 0413 214 066 – Facebook: Tamborine Mountain Rugby

TM TENNIS CLUB: Social tennis from 6.30pm Mon, 7.00am Tue, 6.30pm Wed and 3.00pm Sun. Ladies from 7.00am Fri. Fit Hit (cardio) 6.30pm Tue. For all sessions, no need to book, just turn up. 88 Beacon Rd North Tamborine. Contact Henry Rich 0477 775 671

TM WRITERS GROUP: Meets every 1st & 3rd Mon of month, 1.30–3.30pm at Creative Arts Centre, Eagle Heights. Call Patricia on 5545 3403 for details.

UNIVERSITY OF THE THIRD AGE (U3A). An association for retirees and those preparing for retirement. Learn, teach, socialise. For more info please access our website www.u3atamborinemountain.com

YOGA: For beginners to advanced students: Hatha, Tantra and Nada Yoga. Tues 9.30am, Sat 9am at the Zamia and Wed 6pm Creative Arts Centre. Margot Wagner 0428 137 391

ZUMBA GOLD: Zumba Gold: dance fitness classes for deconditioned participants and active older adults. Mondays and Thursdays 9.30am at the Zamia. Petra Hunter 0414 505 014 – TamborineMountainZumba@gmail.com



RENT 4 2 2 933 m²

42-46 Pacific Parade, Tamborine Mountain

Quiet part of town - opposite the 9th hole

- Modern kitchen, central living room with air-con & fireplace
- Private and separate cabana at the rear of the property, great place to entertain and for the kids to play
- Available 9th March
- Pets considered on application
- Rental \$700.00 per week

AGENTS:

Amy Orr 0474 315 000
Sarah Lewis 0429 001 013



Under Offer 4 2 2 304m²

1 Mangano Court, Yarrabilba

Everyone wins at Professionals!

Natasha & Andrew are volunteers for the rural fire brigade who have been helping save lives in this latest rain event. They are happy that their rental property has sold to an investor so they can stay put and focus on what really matters!

Interested in a current market report & value of your property?
Call for a complimentary one!

Agents:

Charmaine Wiggleworth 0460 444 100
Linda Hogan 0414 300 558



Our Sales Consultants are here to help. To give you an informed, current market appraisal, and to assist you with any questions you may have. Give them a call

